

Sultan

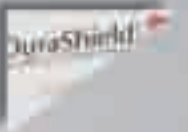

Sultan Healthcare
Quality infection control, dental
materials, preventives and oral
therapeutic products since 1872.

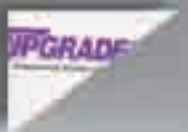

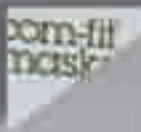

Sultan®

A reputation for quality products and outstanding service since 1872.

Sultan Healthcare is dedicated to providing the global healthcare community with innovative products and fast, reliable service. Our on-going commitment to research and development allows us to constantly offer exciting new products. To solidify our presence in the market, we have global distribution centers located in the United States, Canada and Europe for fast, efficient product delivery and a global sales team in place to support our customer needs.

The Sultan tradition began in 1872, when Edward Sultan founded the original Sultan Pharmacy on 23rd Street in New York City. The pharmacy dispensed prescription and over-the-counter drugs and was popular for its lunch counter. In the 1930's, the New York University School of Dentistry opened just one block away. Since Sultan filled prescriptions for the school, it wasn't surprising that graduate dentists continued to send their prescriptions to Sultan for their dental pharmaceuticals. As more and more dentists turned to Sultan in the 1940's, a small manufacturing area replaced the lunch counter. By 1955 Sultan required more manufacturing and inventory space and moved to New Jersey. Sultan closed the pharmacy and devoted all its efforts to manufacturing products for sale to dentists and dental dealers.

Over the course of our 135 year history, Sultan Healthcare has grown to be one of the world's leading manufacturers of infection control products, dental materials, preventives and oral therapeutics. Our distribution partners and dental and healthcare practitioners worldwide count on us for innovative quality products, superior customer service, premium marketing support and continuous profitability.



TABLE OF CONTENTS

MATERIALS AND RESTORATIVES	4-33
GENIE™ VPS Impression Materials	6-7
GENIE™ MAGIC MIX Impression Materials	8-9
GENIE™ BITE, Bite Registration Material	10-11
SILGIMIX™ Alginate Replacement Impression Material	12-13
3WAY™ Disposable Impression Trays	14-15
DENTRAY® II Disposable Impression Trays	16
SULPAK™ and ULTRAX™ Retraction Cords	17
Gun Racks & Impression Syringes	18-19
VERSA-TEMP® Temporary Crown and Bridge Resin	20-21
TEMP-ART™ Acrylic Resin Temporary Material	22-23
SENSITEMP® Temporary Cement	24-25
VERSA-LINK® Porcelain Bonding and Repair System	26-27
TOPEX® Polishing Pastes	28-29
HYDRO-CAST® Tissue Treatment	30-31
VERSA-SOFT™ Silicone Soft Lining Material	32-33
INFECTION CONTROL PRODUCTS	34-65
PUREVAC® HG Mercury Capture System	36-37
PUREVAC® Evacuation System Cleaner	38-39
SOLO™ Disinfectant Cleaners	40-41
LYSOL® I.C.™ Surface Disinfectants	42-43
SURFLETS™ Surface Disinfectant Tablets	44
SOAPLETS™ Foaming Hand Soap Tablets	45
GLOVE RELIEF™ Hand Lotion	45
LYSOL® I.C.™ Hand Soap	46
INSTAFRESH™ Hand Sanitizer	47
COM-FIT™ Face Masks	48-51
Instruments Reprocessing Techniques	52-53
ZymeX™ Enzymatic Cleaners	54-55
PRO•PORTION™ Ultrasonic Cleaning Solutions	56
CLEANLETS™ Ultrasonic Cleaning Solutions	57
PRO•SONIC™ Ultrasonic Cleaning Solutions	57
PRO•SONIC™ Ultrasonic Machines	58-59
ASSURE-PLUS™ Self-Seal Sterilization Pouches	60
PEEL-PRO™ Self Sterilization Pouches	61
SPOROX® II Sterilization & Disinfecting Solution	62
1-SHOT™ Disposable Needles	63
PRO-TIP® Air/Water Syringe Tip System	64-65
PREVENTIVES	66-77
Guide to Oral Care	68-69
TOPEX® Topical Anesthetics	70-71
UPGRADE® Angles	72
TOPEX® Prophylaxis Pastes	73
TOPEX® In-Office Fluorides	74
TOPEX® 2-Part In-Office Fluoride Rinse Kit	75
DURASHIELD™ 5% Sodium Fluoride Varnish	76
TOPEX® Take Home Care® Fluoride Gels	77
ENDODONTIC PRODUCTS	78-83
Root Canal Irrigants	79
Devitalizers & Disinfectants	80-81
Root Canal Sealers	82-83
OPERATIVE PRODUCTS	84-87
Bleaching Agents and Cements	85
Sodium Fluoride Desensitizing Paste	86
Desensitizers and Dry Socket Paste	86-87
LABORATORY AND GENERAL PRODUCTS	88-89
INDEX	90-91

MATERIALS AND RESTORATIVES

Sultan®

Advanced Materials For Superior Function and Esthetics

Today's patients are increasingly demanding that their restorations and dental prosthetics not only be functional, but also look better while providing greater comfort.

Sultan's full line of restorative materials helps you exceed patient expectations!





Ultra Hydrophilic Impression Material



Ultra Hydrophilic Impression Material



Genie Bite Registration Material



Alginate Replacement Impression Material

Versa-Temp®

Temporary Crown & Bridge Resin

TempART™

Acrylic Resin Temporary Material

SensiTemp®

Temporary Cements

Versa-Link®

Porcelain Bonding & Repair System

HYDRO-CAST®

Tissue Treatment & Functional Impression Material

Versa-Soft™

Silicone Denture Soft Lining Material

Topex®

Polishing Pastes

MATERIALS AND RESTORATIVES

Sultan

GENIE™ VPS Impression Materials

Genie™ is a superior ultra-hydrophilic vinyl polysiloxane dental impression material that gives you premium performance at a value price...and a great blast of Berry flavor that your patients will love.



Dual Phase Technique:



X-Light Body Light Body Regular Body Heavy Body

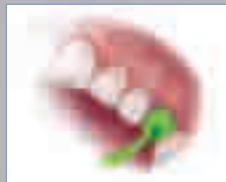

Syringe Genie XLB or LB around the tooth/teeth



Load the tray with Genie HB



Seat the tray

Double Impression Technique:



Mix part A and B putty together and load into tray



Seat the tray



Remove impression and relieve areas around prepared teeth with a carbide bur



Syringe LB, XLB or RB around prepared teeth



Re-seat the tray



Ordering Information

GENIE VPS	Rapid Set (2:10)	Standard Set (4:30)
Extra Light Body	77600	77605
Light Body	77610	77615
Regular Body	77620	77625
Heavy Body	77630	77635

GENIE VPS INCLUDES:

2-Pack Berry Flavored
2x 50ml Cartridges,
6 Mixing Tips—XLB
and LB varieties include
6 Intraoral Tips)

BULK KITS	Rapid Set (2:10)	Standard Set (4:30)
Light Body	77720	77725
Regular Body	77700	77705
Heavy Body	77710	77715

GENIE VPS

BULK KITS INCLUDE:

Berry Flavored
(60 Cartridges x 50ml)

GENIE™ PUTTY	Rapid Set (2:30)	Standard Set (4:30)
Putty	77650	77655

GENIE PUTTY INCLUDES:

Berry Flavored
(2 x 300ml jars and 2 scoops)

REFILL MIXING TIPS

REF 72006 **Purple** (7.5 x 11, package of 48)

REF 72001 **Green** (6.5 x 11, package of 48)

REF 72005 **Pink** (5.4 x 12, package of 48)

REF 72003 **Yellow** (4.2 x 12, package of 48)

REF 72007 **Intraoral, Yellow** (Package of 100)



GENIE™ DISPENSER GUN

REF 70051 **Dispenser Gun** (Type S-50, 50ml 1:1)

Technical Specifications

GENIE™ Impression Material	ISO 4823 Class	Shore A @24 hr	Working Time @23°C	Setting Time @23°C	Consistency	Elastic Recovery (%)	Strain in Compression (mix/match)	Dental Reprod (line width)	Max Dim. Change	Color
X-Light Body, RS	Type 3	48	1:05	2:10	47 mm	>99%	4-6%	PASS (@ 20µ line)	<0.2%	Orange
X-Light Body, SS	Type 3	48	2:15	4:30	47 mm	>99%	4-6%	PASS (@ 20µ line)	<0.2%	Orange
Light Body, RS	Type 3	52	1:05	2:10	44 min	>99%	4-6%	PASS (@ 20µ line)	<0.2%	Green
Light Body, SS	Type 3	52	2:15	4:30	44 min	>99%	4-6%	PASS (@ 20µ line)	<0.2%	Green
Regular Body, RS	Type 2	60	1:05	2:10	36 mm	>99%	3-5%	PASS (@ 20µ line)	<0.2%	Blue
Regular Body, SS	Type 2	60	2:15	4:30	36 mm	>99%	3-5%	PASS (@ 20µ line)	<0.2%	Blue
Heavy Body, RS	Type 1	62	1:05	2:10	28 mm	>99%	3-5%	PASS (@ 50µ line)	<0.2%	Purple
Heavy Body, SS	Type 1	62	2:15	4:30	28 mm	>99%	3-5%	PASS (@ 50µ line)	<0.2%	Purple

RS=Rapid Set SS=Standard Set

GENIE™ Putty	ISO 4823 Class	Shore A @24 hr	Working Time @23°C	Setting Time @23°C	Consistency	Elastic Recovery (%)	Strain in Compression (mix/match)	Dental Reprod (line width)	Max Dim. Change	Color
Putty RS	Type 0	70	1:15	2:30	35 mm max	>99%	1-3%	PASS (@ 75µ line)	<0.2%	Purple
Putty SS	Type 0	70	2:15	4:30	35 mm max	>99%	1-3%	PASS (@ 75µ line)	<0.2%	Purple

RS=Rapid Set SS=Standard Set

The single most important feature of an impression material is its ability to flow under pressure. The better the material flows, the more detail you capture beyond the prepared margin. Genie is proven to flow better than other brands providing detail other impression materials simply cannot.

Genie's superior tear strength ensures that the material will not tear when removing the impression.

Genie is available in a full range of wash and tray materials—five viscosities and two set times—that perform like magic.

- Ultra hydrophilic chemistry provides better results in wet oral environments
- Two set times: 2:10 for Rapid Set, 4:30 for Standard Set
- Exceeds ISO 4823 standards for consistency, strain in compression, and detail reproduction
- Excellent flow characteristics under pressure for better surface coverage
- Exceptional batch-to-batch consistency for predictable results every time
- Clean and easy dispensing from Type S-50 dispenser gun
- Dual port cartridge prevents clogs and cross contamination between base and catalyst
- All viscosities are berry flavored to make patients happy

GENIE™ Magic Mix

Genie™ Magic Mix is a fast, easy and economical way to use Genie Impression Material. The new disposable 380ml cartridges have 5% more material than foil bag systems and can be used with automix dispensing machines.



Regular Body



Heavy Body



Monophase Technique:



Syringe Genie Regular Body around the tooth



Load the tray with Genie Regular Body



Seat the tray

- Delicious Berry flavored VPS material in choice of Heavy Body or Regular Body in Rapid Set (2:10) or Standard Set (4:30)
- Fastest Setting automatic machine mix material (2:10)
- Ultra hydrophilic material provides greater accuracy in moist environments
- Non-bursting solid cartridge system ensures reliable handling and usage
- New Genie Magic Mix 380ml cartridge has 5% more material than foil bag systems
- The Genie Magic Mix cartridge has significantly less waste than foil bag systems (28 times less waste)
- New design saves time and frustration often associated with other more complicated and wasteful systems
- Genie Magic Mix is used in automatic impression material mixing machines
- New style dynamic mixing tip eliminates cross contamination of base and catalyst
- Genie Magic Mix is available at a price that will amaze you!

Technical Specifications

GENIE™ Magic Mix	ISO 4823 Class	Shore A @24 hr	Working Time @23°C	Setting Time @23°C	Consistency	Elastic Recovery (%)	Strain in Compression (mix/match)	Dental Reprod (line width)	Max Dim. Change	Color
Regular Body, RS	Type 2	60	1:15	2:10	36 mm	>99%	3-5%	PASS (@ 20μ line)	<0.2%	Blue
Regular Body, SS	Type 2	60	2:15	4:30	36 mm	>99%	3-5%	PASS (@ 20μ line)	<0.2%	Blue
Heavy Body, RS	Type 1	62	1:15	2:10	28 mm	>99%	3-5%	PASS (@ 50μ line)	<0.2%	Purple
Heavy Body, SS	Type 1	62	2:15	4:30	28 mm	>99%	3-5%	PASS (@ 50μ line)	<0.2%	Purple

RS=Rapid Set SS=Standard Set

Ordering Information

MAGIC MIX	Rapid Set (2:10)	Standard Set (4:30)
Regular Body	78800	78805
Heavy Body	78810	78815

MAGIC MIX INCLUDES:
Berry Flavored
(1-380ml cartridge,
10 mixing tips and
1 bayonet ring)

GENIE™ MAGIC MIX ACCESSORIES

REF 78840 **Refill Dynamic Mixing Tips**
(Refill package of 50)

REF 78845 **Magic Mix Bayonet Ring**
(Package of 2)

BULK KITS	Rapid Set (2:10)	Standard Set (4:30)
Regular Body	78820	78825
Heavy Body	78830	78835

BULK KITS INCLUDE:
Berry Flavored
(4-380ml cartridges
and 1 bayonet ring)



GENIE™ BITE, Bite Registration Material

Genie Bite starts off with a light, fluffy consistency that stays where you put it without slumping. Once set, it becomes rock-hard, so it captures and keeps great detail without compressing or flexing during model mounting.



GENIE BITE



GENIE™ BITE, Bite Registration technique:



Inject Genie™ BITE onto occlusal surface.



Instruct patient to bite down and hold for specified set time.



Remove and trim as desired.

Technical Specifications

GENIE™ Bite	ISO 4823 Class	Working Time @23°C	Setting Time @23°C	Elastic Recovery (%)	Max Dim. Change	Color
Fast Set	90	0:45	0:90	>99%	<0.2%	Baby Blue
Super Fast Set	90	0:30	0:60	>99%	<0.2%	Baby Blue

- Light moussy consistency with minimal resistance to closure
- Won't compress or flex upon mounting for exceptionally precise model positioning
- Quick rock-hard set to a shore hardness of 90+
- Super Fast formula sets in 60 seconds; Fast Set formula sets in 90 seconds
- Patient-friendly mint flavor
- Useful as a quick die for temporary inlays and onlays
- Creates extremely accurate edentulous centric relation recordings
- Faster and easier to trim than other bite materials
- Less expensive than the leading bite material
- Dual port cartridge prevents clogs and cross contamination between base and catalyst

Ordering Information

GENIE™ BITE

Mint Flavor (2 x 50ml Cartridges, 6 Green Mixing Tips)

REF 77645 **Super Fast Set** (60 Sec.)

REF 77640 **Fast Set** (90 Sec.)

GENIE™ MIXING TIPS

REF 72001 **Green** (6.5 x 11, package of 48)

GENIE™ ACCESSORIES

REF 70051 **Dispenser Gun** (Type S-50, 50ml 1:1)

Get What You Pay For with all GENIE™ materials.



If you're not careful, you can be cheated by short-filled cartridges. Unlike some brands, Genie gives you a great price and a full 50ml cartridge. When you compare impression materials by weight, you can easily be misled. The fact is, since different viscosities have different weights, the true measure of value is volume, not weight.



Genie's dual port cartridge prevents clogs and cross contamination between base and catalyst.

SILGIMIX™ Alginate Replacement Impression Material...Quicker, Better Impressions Without the Mess!

Silgimix™ is a vinyl polysiloxane material specifically designed to replace messy alginate materials. Silgimix™ is ideal for making impression study models, orthodontic models, counter impressions, provisionals, bleaching trays and more.



Silgimix™ is packaged in disposable 380ml cartridges for automatic mixing machines and 50ml, 1:1 ratio cartridges for S-50 dispenser guns. Silgimix™ sets fast in only 2:10 and has a patient pleasing Mint flavor.



Silgimix™



Mixing conventional alginate for impressions wastes valuable time and is a messy procedure. The Silgimix™ formulation provides a superior alternative. Get great impressions faster and easier with no mess!

- Automixed in choice of 380ml cartridge or convenient 50ml, 1:1 ratio refill cartridges eliminating messy mixing of powder formulations and makes cleanup a snap!
- Fast Set time of 2:10 saves valuable time and keeps patients happy.
- Optimum flexibility makes mouth removal easy and comfortable for the patient.
- Pour Now, Pour Later, Pour Again! Silgimix™ impressions remain dimensionally stable for months so there is no rush to pour. Furthermore, Silgimix™ impressions can be poured multiple times without loss of accuracy.
- Silgimix™ impressions are easily disinfected with glutaraldehydes or Sultan's Sporox® II sterilizing and disinfecting solution eliminating contamination issues often associated with traditional alginate materials.
- Mint Flavored to please all patients
- Silgimix™ is ideal for making impressions that will be scanned as part of a CAD/CAM manufacturing process.

Technical Specifications

Classification	Working Time	Setting Time	Strain-in-Compression	√Final Hardness (Shore "A" scale)	Linear Dimensional Change	Composition	Color	Flavor
ISO 4823, Type 2, Medium Consistency	1:15	2:10	6%	45 @ 24h	0.08%	Addition-cured vinyl polysiloxane	Light Blue	Mint

Ordering Information

SILGIMIX™ MINT FLAVORED

- REF 79010 **Silgimix™ 380ml Single Pack**
(1-380ml Cartridge, 10 Dynamic Mixing Tips and 1 Bayonet ring), Set time- 2:10
- REF 79015 **Silgimix™ 380ml Bulk Pack**
(4 x 380ml Cartridge and 1 Bayonet ring), Set time- 2:10
- REF 79020 **Silgimix™ 50ml 8-Pack**
(8 x 50ml, 1:1 Cartridges), Set time- 2:10
- REF 79025 **Silgimix™ 50ml Bulk Pack**
(60 x 50ml, 1:1 Cartridges), Set time- 2:10

Accessories

- REF 78840 Refill Dynamic Mixing Tips (Package of 50)
- REF 78845 Bayonet Ring (Package of 2)
- REF 72001 Green Refill Mixing Tips for 50ml Silgimix™ (6.5 x 11, package of 48)
- REF 70051 Dispenser Gun (Type S-50, 50ml 1:1)



MATERIALS AND RESTORATIVES

Sultan®

ANTERIOR

3-WAY™ Disposable Impression Trays
Selection and convenience for better, faster impressions.

QUADRANT

SIDELESS
POSTERIOR

POSTERIOR

WIDE BODY
POSTERIOR

3-WAY™ Disposable Impression Trays

Our 3-WAY™ Impression Trays are convenient and assure accuracy in capturing simultaneous master impressions, counter impressions and bite registrations.

- Ergonomically designed handles for easier seating and removal
- Well-defined access ledges and rigid plastic for greater stability
- Thin, non-tear mesh for superior strength
- Patented undercut wall grooves lock impression material to the tray preventing distortion
- Exclusive I.D. Labels permanently affix to tray handle for easy patient and case identification



- | | |
|-------------|--|
| REF AD33000 | Intro Pack Assorted sizes (40 per box) |
| REF AD33001 | Anterior (35 per box) |
| REF AD33002 | Posterior (50 per box) |
| REF AD33003 | Quadrant (35 per box) |
| REF AD33004 | Posterior Sideless (50 per box) |
| REF AD33005 | Wide Body Posterior (50 per box) |

3-WAYTM Disposable Impression Trays Technique:



Inject wash material (Genie Light Body) around the prepared tooth.



Load the tray material (Genie Heavy Body) onto both sides of the 3-WAY tray.

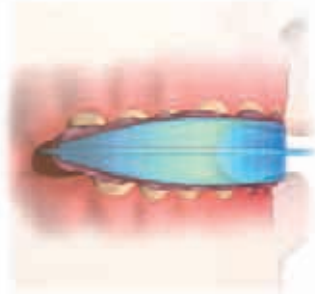

Seat the tray in patient's mouth. Have the patient gently close into the tray.



Remove the tray after the material has set.



Final impression.



Disinfect impression using a liquid chemical disinfectant such as Sporox II or Surflets solution.

Sultan

DenTray® II Disposable Impression Trays

Get the right Impression! Thanks to their rigid design, DenTray® II Impression Trays capture detailed impressions without distortion.

DenTray® II

Disposable Impression Trays

Delivers superior performance and is compatible with all impression materials. Manufactured of high-impact polystyrene, they can be customized by flame or trimming if desired. Both the perforated and solid models are ergonomically designed, and are available in a variety of full or partial trays.

- Made of rigid polystyrene to ensure stability and accurate results without distortion
- 'Slot and dot' design locks impression material in place
- Thermoplastic: can be customized by flame or trimming if desired
- Ergonomically designed with reinforced handle for easy seating and removal

Bag of 12

REF AD33050 Assorted trays (1 of each perforated, 2 each 3P and 4P)

REF AD33051 #1P Large Upper

REF AD33052 #2P Large Lower

REF AD33053 #3P Medium Upper

REF AD33054 #4P Medium Lower

REF AD33055 #5P Small Upper

REF AD33056 #6P Small Lower

REF AD33057 #7P Upper Left/Lower Right

REF AD33058 #8P Upper Right/Lower Left

REF AD33059 #9P Upper Anterior

REF AD33060 #10P Lower Anterior

REF AD33061 #7S Upper Left/
Lower Right Solid

REF AD33062 #8S Upper Right/
Lower Left Solid

REF AD33063 #9S Upper Anterior Solid

REF AD33064 #10S Lower Anterior Solid



DenTray® Dual Phase Technique:



Syringe Genie XLB or LB
around the tooth/teeth



Load the tray with
Genie HB



Seat the tray

SULPAK™

ULTRAX™

Sultan Retraction Cords

Sulpak™ and Ultrax™ Gingival Retraction Cords offer a super-absorbent solution to control bleeding in the sulcus.



Soft, memory-free and easy to pack. Sulpak™ wound cord and Ultrax™ braided cord are available in a choice of 3 hemostatic solutions: Astringent – Aluminum Potassium Sulfate NF; Vasoconstrictor – Racemic Epinephrine HCL; and Combination – Aluminum Potassium Sulfate and Racemic Epinephrine. Color-coded labels provide easy identification.

- Soft, memory-free, super-absorbent retraction cords that pack easily
- Available in a choice of 3 hemostatic solutions to control bleeding in the sulcus
- Unique “Pull ‘n Cut” Dispenser allows quick, convenient and waste-free dispensing
- Dispenser labels are color-coded for easy identification
- 72 inches (183cm) of cord per package

SULPAK™

Thin Wound - 0.48mm diameter
Medium Wound - 0.81mm diameter
Large Wound - 1.19mm diameter

ULTRAX™

Thin Braided - 0.5mm diameter
Medium Braided - 0.75mm diameter
Large Braided - 1.0mm diameter

Retraction Cord Technique:



Pull out the desired amount of cord.



Use the built-in blade to cut cord to desired length.

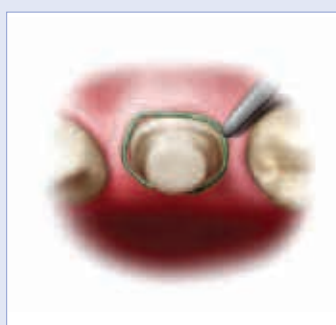

Pack the retraction cord into the sulcus using a cord packing instrument.



Retraction Cord in place.



SULPAK™ (WOUND) - 72" (183cm) cord/pkg	THIN	MEDIUM	LARGE
Aluminum Potassium NF	AD34001	AD34002	AD34003
Racemic Epinephrine HCL	AD34004	AD34005	AD34006
Aluminum Potassium and Epinephrine	AD34007	AD34008	AD34009
ULTRAX™ (BRAIDED) - 72" (183cm) cord/pkg	THIN	MEDIUM	LARGE
Aluminum Potassium NF	AD34010	AD34011	AD34012
Racemic Epinephrine HCL	AD34013	AD34014	AD34015
Aluminum Potassium and Epinephrine	AD34016	AD34017	AD34018

Sultan Healthcare Gun Racks

Our Gun Racks make organizing all of your dispensing guns and mixing tips simple.



Sultan Healthcare Gun Racks

Solid acrylic construction make them durable and sturdy. The gun racks are ideal for every operator in your office and are available in a 2-slot or 4-slot models.

- Storage compartments suitable for all size mixing tips — no more searching for the right mixing tip, they are where you need them every time
- All size and style guns fit in either the 2-slot or 4-slot style
- Solid plastic makes cleanup easy and fast

REF 70052 **Dispenser Gun Rack- 2-Slot**

REF 70053 **Dispenser Gun Rack- 4-Slot**

DISPENSER GUNS

REF 70025 **Dispenser Gun** (Type S-25, 25ml 1:1)

REF 70051 **Dispenser Gun** (Type S-50, 50ml 1:1)

REFILL MIXING TIPS

REF 72006 **Purple** (7.5mm x 11, package of 48)

REF 72001 **Green** (6.5mm x 11, package of 48)

REF 72005 **Pink** (5.4mm x 12, package of 48)

REF 72003 **Yellow** (4.2mm x 12, package of 48)

REF 72007 **Intraoral, Yellow** (Package of 100)

REF 70035 **Blue** (3.2mm x 12, package of 50)



Disposable Impression Syringes

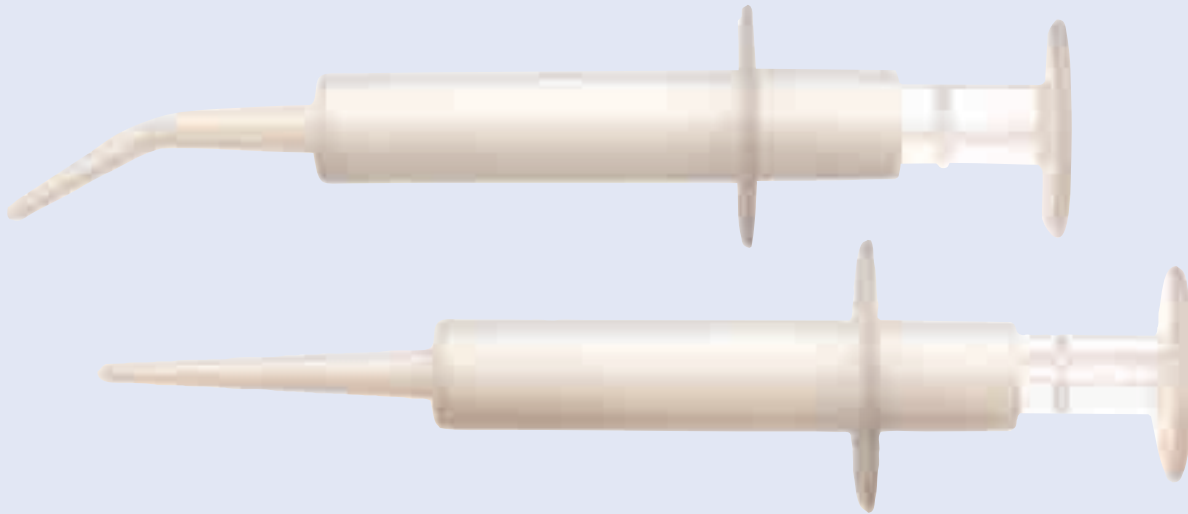

Disposable Impression Syringe

Delivering impression material is easy and reliable with the Sultan Disposable Impression Syringe. Extended, tight-fitting plunger provides better leverage and reduces waste. Seamless construction prevents splitting during extrusion. Syringe tips are adjustable by cutting or bending to reach all areas.

- Seamless design, will not split apart during delivery
- Enlarged thumb tab for easy non-slip application
- Smooth sliding, longer plunger provides better leverage and more even application of impression material

REF AD36001

50 Disposable Impression Syringes

Loading the syringe from an automatic delivery machine.



Step 1: Place Impression Syringe at base of mixing element.



Step 2: Load the Syringe with the desired amount of Impression material.



Step 3: Insert plunger into Syringe.

MATERIALS AND RESTORATIVES

Sultan™

Versa-Temp™ Temporary Crown and Bridge Resin: Automix Ease, Uncompromised Esthetics

Not only is Versa-Temp a functionally and esthetically superior provisional material, it's also a great diagnostic tool for ensuring long-term restorative success. Versa-Temp temporaries provide an extremely accurate advance preview of the permanent restoration. This gives you and your patients a unique opportunity to adjust the fit, color and shape of the temporary chairside, resulting in terrific provisionals and providing a blueprint for perfect permanent restorations.

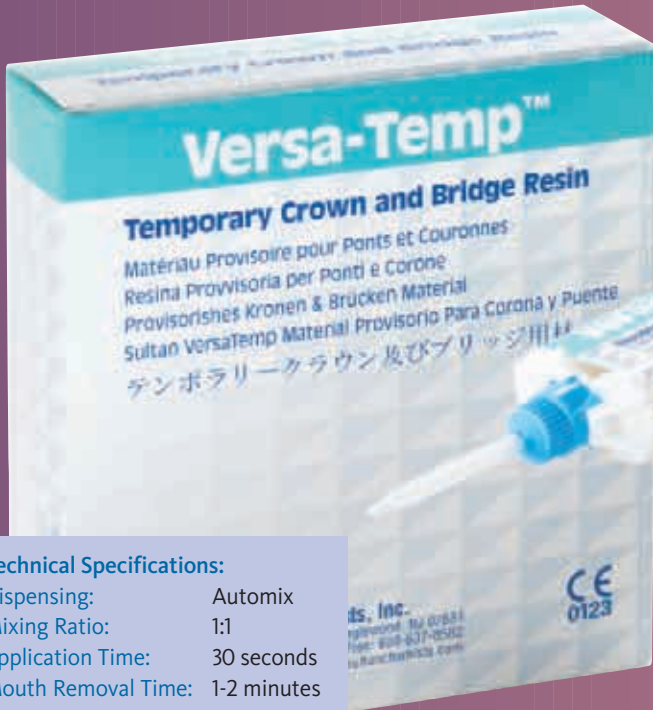

Technical Specifications:

Dispensing:	Automix
Mixing Ratio:	1:1
Application Time:	30 seconds
Mouth Removal Time:	1-2 minutes
Setting Time:	3-4 Minutes (in matrix)
Finishing:	>4 minutes
Flexural Strength:	>70 MPa
Compressive Strength:	205 MPa
Max Setting Temp.:	40°F



Versa-Temp™ Temporary Crown and Bridge Resin features:

- A unique composite-based resin chemistry that provides superior strength and hardness for all of your routine restorative procedures
- The ability to create high performance provisionals that look and feel like final restorations
- 6 beautiful Vita*-matched shades (AO-Bleach, A1, A2, A3.5, B1 and C2)
- A working time of 1.5 minutes and a setting time of 4 minutes
- 5ml, 25ml and 50ml clog-proof, 1:1 cartridges that makes it easier to handle and dispense
- Smaller mixing tips that reduce waste by up to 15%
- Patient-friendly formula with no harmful heat generation
- Can be accurately custom-characterized with the 6 stains in the LC Stain Kit
- Provides a natural look and sheen when used with Gloss Cote light cure varnish

*Vita is a registered trademark of Vita Zahnfabrik, Bad Sackingen

Versa-Temp 5ml 1:1 Automix Hand Syringe Kit

REF 72080	Shade A1
REF 72085	Shade A2
REF 72090	Shade A3

REF 70031 Refill Brown Mixing Tips (2.5mm x 8), 5ml Syringe, Pkg. of 20

REF 72010 Versa-Temp 25ml Introductory Kit

25ml Refill Kits	1-25ml Cartridge, 10 Mixing Tips
REF 72035	Shade AO - Bleach

REF 72015
REF 72020
REF 72025
REF 72030
REF 72040

Shade A1
Shade A2
Shade A3.5
Shade B1
Shade C2

REF 70035

Refill Blue Mixing Tips
(3.2mm x 12), 25ml and 50ml Cartridge, Pkg. of 50

50ml Refill Kits

REF 72050	Shade A1
REF 72055	Shade A2
REF 72060	Shade A3

50ml Bulk Kits

REF 72065	Shade A1
REF 72070	Shade A2
REF 72075	Shade A3

Fabrication of a Temporary Crown:



Make a matrix using Genie Putty mixing equal parts of base and catalyst.



Form the matrix over an intact tooth or a wax-up. Allow the putty to set and remove. Prepare the tooth.



Select the appropriate shade of Versa-Temp and dispense the material directly into the matrix.



After tooth preparation, seat the matrix back in the mouth ensuring that the matrix is fully seated. After 90 seconds remove the matrix from the mouth.



Using carbide or diamond burs, trim the margins and check the fit/occlusion of the temporary crown in the mouth. Apply GlossCote if desired.



Select the appropriate temporary cement (SensiTemp Resin, NEZO, ZOE) and dispense the cement directly into the crown.



Seat the crown in the mouth and hold firmly in place (or have the patient close into a cotton roll placed over the crown).



Remove excess cement. Perform final occlusion check and make adjustments as necessary.

Use the TempArt LC Stain Kit and GlossCote Light-Cure Varnish to achieve stunning results with all temporary crown and bridge materials, including TempArt and Versa-Temp!



The TempArt Light Cure Stain Kit features:

- 6 stains that you can use to accurately simulate the subtle shading, highlights and color variations of natural tooth structure
- 6-5ml bottles of the following colors: Yellow, Blue, Gray, White, Brown and Burnt Amber
- Unsurpassed ability to custom-characterize temporary restorations

REF 71087 TempArt LC Stain Kit

6-5ml Bottles: Yellow, Blue, Gray, White, Brown, Burnt Amber



GlossCote Light Cure Varnish features:

- Forms a durable, glossy coating that lends a lifelike sheen to all acrylic and composite resin temporary materials
- Delivers a beautiful polished-looking surface faster and with far less effort than mechanical polishing
- The hard, glossy surface helps to minimize the accumulation of plaque and debris, providing greater protection for the involved teeth
- Makes a great bonding agent for relining composite temporaries

REF 71090 GlossCote Light Cure Varnish 1-15ml Bottle

Sultan™

TempART™ Acrylic Resin Temporary Crown and Bridge Material: Stunning Esthetics and Superior Handling

TempART is the most esthetic, best handling, highest strength chairside acrylic resin temporary crown and bridge material on the market.

TempART's internal colorization technology gives you the ultimate in esthetic control. It allows you to create temporaries that exhibit a remarkable level of color depth and translucency...in an infinite number of natural-looking shades!

TempART™ features:

- 5 Vita*-matched base shades: A1, A2, A3.5, B1 and C2
- 5 internal modifier tinting powders (enamel, yellow, white, brown and gray) are used to intrinsically color the temporary as it is fabricated
- An instantly dissolving resin powder yields a smooth, creamy mixture for easier handling
- A self-curing liquid is ideal for both chairside and laboratory use (a heat-cure liquid is also available)
- 6 stains in the TempART LC Stain Kit add amazingly lifelike details and shading
- GlossCote Light Cure Varnish for a hard, durable, glossy finish without mechanical polishing

TempART's unique acrylic resin chemistry provides superior strength and durability, creating high performance provisionals that simulate the look and feel of the final restoration.

REF 71010 TempART Introductory Kit
1-100ml Dropper Bottle Liquid, 5-Shades Resin Powder, 5-Intrinsic Modifier Shades, 1-LC Stain Kit (6-5ml Bottles: Yellow, Blue, Gray, White, Brown, Burnt Amber), 1-15ml Bottle of GlossCote, 1-Mixing Dish

REF 71041 TempART A2 Refill Kit
100g A2 and 100ml liquid

REF 71015 TempART Powder Refill
50g, Shade A-1

REF 71020 TempART Powder Refill
50g, Shade A-2

REF 71025 TempART Powder Refill
50g, Shade A-3.5

REF 71030 TempART Powder Refill
50g, Shade B-1

REF 71035 TempART Powder Refill
50g, Shade C-2

REF 71040 TempART Self Cure Liquid
Refill, 100ml

REF 71045 TempART Heat Cure Liquid
Refill, 100ml

REF 71087 TempART Light Cure Stain Kit
6 x 5ml

REF 71090 TempART GlossCote
Light Cure Varnish, 15ml



Technical Specifications

Working Time:	Determined by user powder/liquid mix ratio
Setting Time:	Should not exceed 4 minutes
Flexural Strength:	>70 MPa
Water Sorption:	19.5 µg/mm ²
Particle Size:	150 µm maximum
Polymer:	Proprietary PEMA/PMMA copolymer

*Vita is a registered trademark of Vita Zahnfabrik, Bad Sackingen

TempART™

TempART™ Technique:

(direct application) or use mixing jar provided



Fabricate a matrix using lab putty or other material.



Mix the TempART powder and liquid until creamy and load into the matrix.



Add the TempART powder (base shades or intrinsic stains) and liquid in a "salt and pepper" fashion.



Seat the loaded matrix in the patient's mouth or on the prepared cast and allow to set.



Trim the temporary as necessary.



If needed, add additional acrylic to the margins.

LC Stain Technique:



Apply LC Stain.



Position light curing unit.



Light cure.

GlossCote® Technique:



When using GlossCote to bond VersaTemp, first brush GlossCote onto the temporary.



Light cure GlossCote.



GlossCote and the LC Stain Kit provide the perfect finish to any restoration.

Use the TempART LC Stain Kit and GlossCote Light-Cure Varnish to achieve stunning results with all temporary crown and bridge materials, including TempART and Versa-Temp!



The TempART Light Cure Stain Kit features:

- 6 stains that you can use to accurately simulate the subtle shading, highlights and color variations of natural tooth structure
- 6-5ml bottles of the following colors: Yellow, Blue, Gray, White, Brown and Burnt Amber
- Unsurpassed ability to custom-characterize temporary restorations

REF 71087 TempART LC Stain Kit

6-5ml Bottles: Yellow, Blue, Gray, White, Brown, Burnt Amber



GlossCote Light Cure Varnish features:

- Forms a durable, glossy coating that lends a lifelike sheen to all acrylic and composite resin temporary materials
- Delivers a beautiful polished-looking surface faster and with far less effort than mechanical polishing
- The hard, glossy surface helps to minimize the accumulation of plaque and debris, providing greater protection for the involved teeth
- Makes a great bonding agent for relining composite temporaries

REF 71090 GlossCote Light Cure Varnish 1-15ml Bottle

MATERIALS AND RESTORATIVES

Sultan®

SensiTemp® Temporary Cements
Take Provisional Cementation
To A Higher Level.

SensiTemp® Temporary Cements

Three automix, desensitizing
temporary cement
formulations for all indications

All formulas contain potassium nitrate to help minimize post-operative sensitivity. All come in automix delivery systems which ensure the perfect mix, with no mess or cleanup and minimal waste (less waste than with tube products): 5ml automix handheld syringe or 25ml automix cartridge for S-25 dispenser guns. All provide the greatest patient comfort while reducing chair time.



Technical Specifications

SensiTemp Product	Working Time	Time to Clean Up	Final Set	Compressive Strength	Film Thickness	Color
NEZO	90 sec.	120 sec.	2-3 min.	10mpa	20 µm	White
ZOE	90 sec.	120 sec.	2-3 min.	10mpa	20 µm	White
Resin	90 sec.	120 sec.	4-5 min.	65mpa	10 µm	White



SensiTemp NEZO

A new non-eugenol, zinc oxide temporary cement formulation that's ideal for all indications.

- Ideal for all indications including inlays, onlays, crowns and bridges
- Extremely retentive, yet easy to remove
- Contains potassium nitrate to help reduce post-operative sensitivity
- Two automix delivery systems provide a consistent, bubble-free mix every time with far less waste than with mixing pads
- Mini mixing tips allow for easier, more precise handling

REF 70050 SensiTemp NEZO 5ml Syringe, 10 Mixing Tips

REF 70055 SensiTemp NEZO 25ml Cartridge with 15 Mixing Tips



SensiTemp ZOE

A new zinc oxide eugenol temporary cement formulation that is ideal for use except where the use of eugenol cannot be tolerated.

- An excellent all-purpose, eugenol temporary cement for crowns and bridges
- High strength, effective sealing, yet easy to remove
- Contains potassium nitrate to help reduce post-operative sensitivity
- Two automix delivery systems provide a consistent, bubble-free mix every time with far less waste than with mixing pads
- Mini mixing tips allow for easier, more precise handling

REF 70040 SensiTemp ZOE 5ml Syringe, 10 Mixing Tips

REF 70045 SensiTemp ZOE 25ml Cartridge with 15 Mixing Tips



SensiTemp Resin

Ideal for all indications, SensiTemp Resin is a high-strength, non-eugenol, resin-based temporary cement formulation

- The ideal cement for high-strength temporary cementation
- Exhibits greater compressive strength than most temporary cements, yet remains easily removable
- Perfect for short and long term wear
- Does not contain eugenol so it will not interfere with permanent cementation
- Provides permanent, yet reversible cementation of implant-retained crowns
- Contains potassium nitrate to help reduce post-operative sensitivity
- Two automix delivery systems provide a consistent, bubble-free mix every time with far less waste than with mixing pads
- Mini mixing tips allow for easier, more precise handling
- Not for use with inlays, onlays or for provisional cementation of final restorations

REF 70010 SensiTemp Resin 5ml Syringe, 10 Mixing Tips

REF 70020 SensiTemp Resin 25ml cartridge, 15 Mixing Tips

SensiTemp Accessories

REF 70025 Dispenser Gun Type S-25

REF 70030 Refill Mixing Tips (2.5mm x 8), For 5ml Syringe, Pkg 20 (Brown Blunt)

REF 70031 Refill Mixing Tips (2.5mm x 8), For 5ml Syringe, Pkg 20 (Brown Needle)

REF 70035 Refill Mixing Tips (3.2mm x 12), 25ml Cartridge, Pkg. of 50, blue tip

SensiTemp Technique



Dispense SensiTemp directly into the temporary restoration. SensiTemp's smaller mixing tips provide easier, more precise handling.



Have patient gently close onto a cotton roll. Excess SensiTemp will be clearly visible and easily removable.



Approximately 90 seconds after the start of the mix, simply peel away any excess cement.

Dual Port Design



Dual-port design prevents clogs and cross-contamination between base and catalyst.

Sultan

Versa-Link®: The Best Way to get Predictable Results the First Time.

Our Versa-Link Porcelain Bonding Kit is used to bond new all-ceramic restorations, and repair damaged ceramo-metallic restorations. It is also effective for composite-to-composite bonding, composite-to-porcelain bonding and bonding of fiber-reinforced resin restorations.



Versa-Link® Porcelain Bonding and Repair System

Bonded porcelain restorations can be one of the most esthetic treatments that you can provide for your patients. With Versa-Link®, bonded porcelain will be the most predictable restoration in your practice. Our superior chemistry and intelligent packaging give you a clear clinical advantage. Here's how:

- Unit-dose, hermetically sealed packaging ensures purity and freshness for 2 years
- Silane is fully activated and ready to use as soon as ampule is opened
- New restorations or repairs are bonded equally well and very predictably
- Eliminate the worries of whether or not your primer will work or if your restorations will bond- they will!
- Available with or without HF Etching Gel

REF 70515 **Versa-Link® Porcelain Bonding & Repair System with Etch**
20 unit-dose ampules of
Silane Primer (0.5ml each),
20 Microbrushes, 20 Transfer
Pipettes, 6% HF Etching Gel

REF 70520 **Versa-Link® Porcelain Bonding & Repair System**
20 unit-dose ampules of
Silane Primer (0.5ml each),
20 Microbrushes, 20 Transfer
Pipettes

Versa-Link Silane Primer Technique:



Unit-dosed in hermetically sealed packaging to ensure purity and freshness for 2 years.



Ready to use as soon as the fully activated primer component ampule is opened.



Using the microbrush supplied, apply a layer of primer to the bonding surface.

Cementing All Porcelain Restorations

Prepare the Restoration for Bonding

1) Check restoration for fit and desired shade.

2) Rinse restoration with water, dry and apply 6% HF porcelain etching gel to the interior or restoration for 90 seconds.

NOTE: Even though porcelain restorations typically are delivered from the laboratory etched, we recommend re-etching and re-priming the surface for optimum bonding.

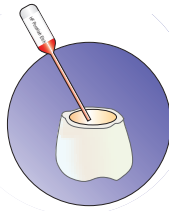

3) Using oil-free air-water spray, rinse the etching gel from the restoration until all traces of red are removed.



4) Using oil-free air, thoroughly dry the bonding surface of the restoration.

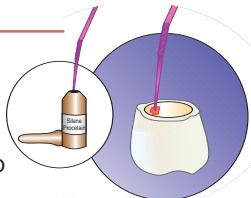

5) Open an ampule of Versa-Link using the supplied microbrush, apply a layer of primer to

the restoration. Allow the primer to set on the surface of the restoration for a minimum of 3 minutes.

6) Using oil-free air, thin the primer.

NOTE: The primer will not evaporate—a visible wet layer should be present.

Prepare the Tooth for Bonding

7) Apply appropriate bonding system to prepared tooth.**

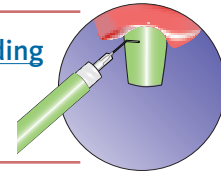

Cement the Restoration

8) Mix the dual-cured adhesive resin cement, or light-cured cement per the manufacturers directions.** Load the mixed cement into the prepared restoration(s).



9) Gently seat the restoration on the preparation. Use a composite handling instrument to remove the excess cement.

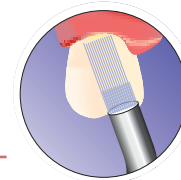

10) Light cure all facets of the restoration.

**Note: Not included in the Versa-Link system.

*For detailed instructions on porcelain repair, go to www.sultanhealthcare.com

What Does Silane Do?

Why do you need to use a porcelain primer when cementing a porcelain crown? The answer is that cements and composites adhere poorly to porcelain—the surface is just too low in energy to obtain a decent bond. Our primer chemically couples to the porcelain surface making it receptive to bonding materials. One side of the primer molecule adheres to the surface and the other reactive monomer side of the molecule reacts with the resin cement or composite. The success of this reaction depends on fully active primer that has not been compromised by oxygen or light. We protect our primer in a hermetically sealed, inert atmosphere unit-dose ampule giving you the most pure and fully reactive primer available.

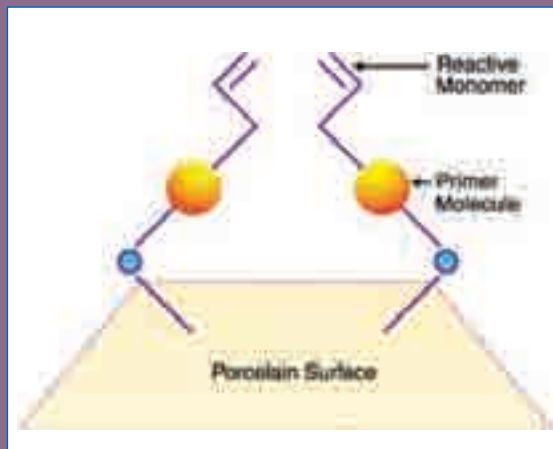



Topex® Prep & Polish™ Paste

Prep & Polish is a convenient, fast and easy way to clean and prepare tooth surfaces prior to bonding or cementation. The Prep & Polish formulation does not contain additives, oils, waxes or flavors which can interfere with bonding surfaces.

- Exclusive formula contains flour of pumice and is free of fluoride, flavor, oil, wax or dyes.
- Use Prep & Polish to clean tooth surfaces prior to orthodontic bonding, placement of sealants and cementation of permanent bonded restorations
- Great for use with homeopathic patients or patients who are allergic to colors and flavors

REF AD30045 **Topex Prep & Polish**, 100- 2gm cups with prophy ring and 2 Upgrade prophy angles



Preparing a tooth with Prep & Polish paste prior to cementing orthodontic brackets.

Topex® Polishing Pastes

Topex® Polishing Pastes

Topex polishing pastes are ideal for polishing restorations chairside. The convenient syringe delivery is easy to dispense and store. The exclusive formulations polish quickly making all restorations look beautiful and feel great.



Topex® Composite Polishing Paste

For use with Composite Restorations, Amalgams and Castings.

- Creates a high-level polish and luster quickly and easily
- High-viscosity, non-drying consistency contains pure refined corundum powder suspended in a non-splattering binder
- Assures smooth luminosity with no surface grooves or unevenness
- Peppermint flavored

REF AD30050 Topex Composite Polishing Paste, 1 x4g Syringe/box



Topex® Brilliance™ Micrograin™ Diamond Polishing Paste

For use with Porcelain Crowns, Bridges, Veneers, Inlays and Onlays.

- Restores original smoothness to all ceramics resulting in a superior finish
- Abrasive consists of pure diamond powder to create high luster and shine
- Used to restore surface after occlusal adjustment
- Peppermint flavored

REF AD30052 Topex Brilliance™ Micrograin™ Diamond Polishing Paste 1- 3g syringe/box



Polish ceramic crown with Topex Brilliance.



Finished restoration.

Sultan



HYDRO-CAST®: The Only Material that Gives You Predictable Results for Removable Prosthetics



HYDRO-CAST® Features:

- A clinically proven formula that stays soft and functionally flexible for weeks
- A tissue conditioner that works to return edentulous tissues to a normal state
- An interim soft-lining for immediate full dentures, interim partial dentures, or after implant placement surgery
- A predictable denture impression material
- A reliable diagnostic tool that functionally stabilizes the denture base
- Great for fabricating diagnostic dentures when planning implant cases
- Methyl methacrylate-free and patient-friendly
- Easy-to-use 2-component powder/liquid format

Technical Specifications

Mixing Ratio:

Powder: Liquid 1:1 (v/v) for Maxillary
1.25:1 for Mandibular

- REF 73010 **HYDRO-CAST Introductory Kit**
1- 130gm Bottle of Powder, 1- 115ml Bottle of Liquid, 1- 8ml Bottle of Flow Replenisher, 2 Glass Measuring Vials and 1 Mixing Glass
- REF 73015 **HYDRO-CAST Liquid**
1-115ml Bottle of Liquid Only
- REF 73018 **HYDRO-CAST Flow Control**
1- 8ml Flow Control Bottle Only
- REF 73020 **HYDRO-CAST Powder**
1- 130gm Bottle of Powder Only
- REF 73025 **HYDRO-CAST Wetting Agent**
2- 115ml Bottle of Liquid
- REF 73030 **HYDRO-CAST XFS Resin**
100ml liquid, 200g powder
- REF 78246 **Kayon Denture Tinting Stain Kit**
10g each of A, E, F, H and B, 60ml Liquid
- REF 73017 **HYDRO-CAST TT Bulk Package**
6- 130g Bottle of Powder, 6- 115ml Bottle of Liquid

HYDRO-CAST® Technique:



Follow-Up Visits

Remove the dentures from the patient's mouth and rinse them under running water. Examine the tissue surfaces of

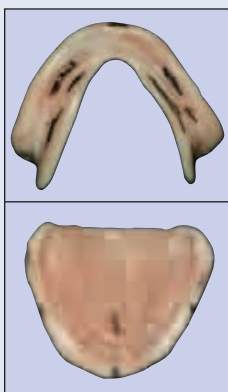

the dentures for border over extensions, border under extensions and tissue impingements. Border over extensions and tissue impingements are visible as hard denture base material showing through the white Hydro-Cast® resin. These are relieved using a carbide bur and repaired using freshly mixed Hydro-Cast® Tissue Treatment Material applied to the defect. Border under extensions are visible as unsupported areas of Tissue Treatment Material greater than 3-4 mm in length. These areas must be "backed up" using Hydro-Cast® XFS Autopolymerizing Resin to provide support. Free "tags" of Hydro-Cast® Tissue Treatment Material can be removed from or reattached to the denture base using a hot spatula to trim and shape the

material. An occlusal evaluation should be performed at every follow-up appointment. Hydro-Cast® Tissue Treatment Material significantly improves denture stability making occlusal evaluations easier and more reliable. The consistency and color of the patient's denture bearing tissue should be monitored at each appointment. For patients with extremely inflamed tissue, the Hydro-Cast® Tissue Treatment Material may need to be changed as healing takes place. Schedule an additional follow-up visit 24-48 hours from the initial follow-up visit. At the second and subsequent follow-up visits, repeat the evaluation of the impression surface, oral tissue and occlusal relationships. Once all 3 areas are satisfactory to both the patient and dentist, the denture may be sent to a laboratory for relined or rebased.

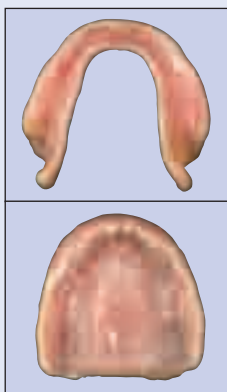

HYDRO-CAST®

Mixing and Placement:

- ❶ Use 1.25 parts powder to 1 part liquid for a mandibular denture, 1 part powder to 1 part liquid for a maxillary denture.
- ❷ Pour the liquid into the shot glass supplied with the kit.
- ❸ Pour the powder into the liquid and mix the 2 parts together quickly (just a few seconds).
- ❹ Cover the mixing container with a watch glass or something else that is solid.
- ❺ Allow the mixture to set covered 5-7 minutes.
- ❻ At about 5 minutes, check the mixture. A proper mixture for a maxillary denture should be like molasses. A proper mixture for a mandibular denture should be like soft butter.



- ❼ Apply the Hydro-Cast to the denture, working with one denture at a time.
- ❽ Trim the excess material with a heated spatula or Bard-Parker scalpel blade.

MATERIALS AND RESTORATIVES

Sultan

Versa-Soft™ is the Only Long-lasting Silicone Soft Denture Liner with a 2-year “Stay-Put, Stay-Soft and Stay Comfortable,” Satisfaction Guarantee.

Versa-Soft is a medical grade silicone denture soft liner with a difference: a unique primer system that resists degradation, resulting in dramatically longer service life with improved patient comfort and security.



Versa-Soft™ Technique:



Prepare the acrylic surface. Remove existing surface acrylic to a depth of 1-3 mm.



Using the supplied UltraBrush, apply one or two layers of Versa-Soft Primer, allow the primer to completely dry.



Apply Versa-Soft to the denture surface to a minimum thickness of 2-3 mm.



Trim the gross excess using a sharp scalpel or scissors. Smooth rough areas and shape borders using the supplied silicone trimmer.

Versa-Soft™ increases the comfort and performance of any removable denture. Ideal for use wherever a soft resilient denture material is needed.

- The most adhesive, longest lasting automix chairside permanent denture relining material
- Easy-to-use, quick setting, reliable and durable
- Adheres tenaciously to acrylic resins, remains soft indefinitely and won't absorb odors
- Does not contain methyl methacrylate or other harmful monomers
- Provides a high degree of comfort for denture wearers

- Long-lasting – will not permanently distort, dry out or lose plasticizer

REF 74010 Versa-Soft Introductory Kit

1-25ml Cartridge, 8 Mixing Tips, Primer, Varnish, 10 Brushes, Trimmers, Type S-25 Dispenser Gun

REF 74012 Versa-Soft Standard Kit

1-25ml Cartridge, 8 Mixing Tips, Primer, Varnish, 10 Brushes, Trimmers

REF 74015 Versa-Soft Refill Kit

1-25ml Cartridge, 8 Mixing Tips

Versa-Soft will “Stay-Put, Stay-Soft and Stay Comfortable” for at least two years, guaranteed.

INFECTION CONTROL PRODUCTS

Sultan

PUREVAC®

Evacuation System Cleaners

PUREVAC Hg

Mercury Capture System



The All-in-One Disinfectant Cleaners



Hand Care, Surface Disinfectants and Cleaners



Surface Disinfectant Tablets



Anti-microbial Hand Soap Tablets



Instant Hand Sanitizer

com-fit™

Face Masks



Your Source for Quality Infection Control Products

Sultan Healthcare Infection Control products help you maintain a clean, healthy environment while adhering to regulatory requirements. We provide quality branded products that complete the cycle of infection control.



zymex

Enzymatic Cleaners

CLEAN 175

Ultrasonic Cleaning Tablets

PRO-PORTION
Ultrasonic Cleaning Solutions

Ultrasonic Cleaning Solutions

PRO-SONIC

Ultrasonic Machines and Solutions

SPOROX[®] II

Sterilizing and Disinfecting Solution

ASSURE Plus[™]

Self Seal Sterilization Pouches

PeelPro[™]

Self Seal Sterilization Pouches

1SHOT

Disposable Dental Needles
Dental Needles

PRO-TIP
ULTRA

Disposable Air/Water Syringe Tips

Sultan

To capture and remove the most mercury, you need more than a separator...you need a system.

PUREVAC® Hg Evacuation System Cleaner

The PUREVAC® Hg Evacuation System Cleaner combines the cleaning power of PUREVAC® with patented ingredients that bind colloidal and dissolved mercury into larger particles making them easier to capture. The result is an environmentally friendly solution that keeps evacuation lines clean and running at optimal suction.

- Patented formulation binds small/liquid particles into larger ones improving mercury capture in amalgam separators
- Provides effective evacuation system cleaning
- Fresh citrus lime fragrance
- Slightly alkaline formulation, safe for use with any amalgam separator
- Biodegradable formula
- Economical concentrated formula, 1oz (30ml) makes 1 quart (.95L) of solution

REF 21151 1 Quart (.95L) bottle
(32 treatments)

REF 21155 5 Liter (167oz) bottle
(167 treatments)

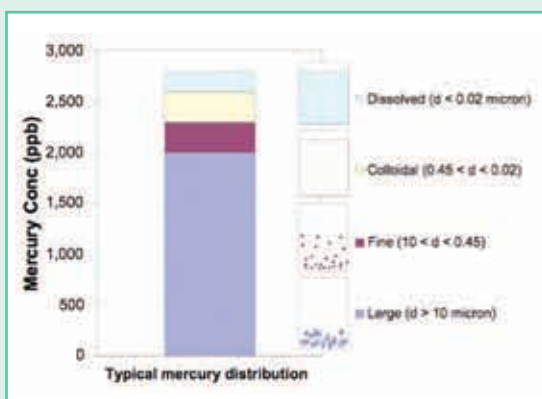

Mercury Particle Sizes in Dental Wastewater

Amalgam particles containing Mercury that are less than 10 micron are the most difficult to capture using traditional amalgam separators (sedimentation and centrifugal systems). The majority of amalgam waste is larger than 10 micron, but there is still fine particles, colloidal and dissolved mercury that can enter the waste stream.*

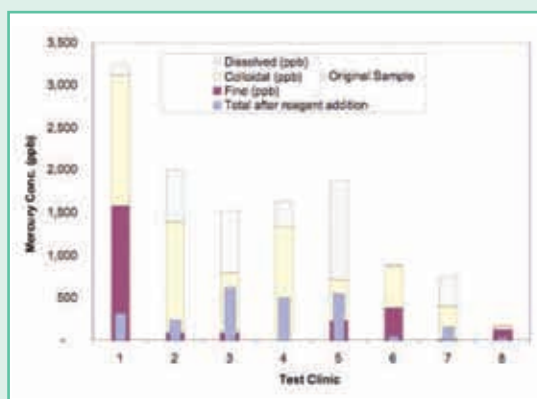

Reduction in small mercury particles (<10 micron) with PUREVAC Hg reagent.

PUREVAC Hg Evacuation system cleaner contains a reagent that helps combine smaller particles making them easier to capture. The table shows the greatly improved efficiency when using PUREVAC Hg Evacuation System Cleaner.*

*Source: ADA Technologies, "Enhanced Dental Amalgam Trap," Final Report, National Institute for Dental & Craniofacial Research, Grant No. 5 R44 DE014010-03, December 28, 2004.



Sultan Healthcare and Solmetex have joined forces to provide a patented, two-part process to effectively remove mercury. The combination of PurevacHg5 removes over 99% of mercury from dental waste water.

Solmetex[®] Hg5[®] Amalgam Separator

- Compact, economical and virtually maintenance free!
- The market leader thanks to its innovative, clear design.
- ISO Certified to capture over 99% of mercury.
- Easy to operate and maintenance free.
- Flexible design for hard-to-fit applications and wet or dry vacuum.
- Professionally engineered, robust, simple design.

Visit www.solmetex.com for more information.

The difference is clear!

Purevac Hg binds smaller mercury particles and sediment allowing it to settle to the bottom of the collection container.



BEFORE



TWO WEEKS LATER...



Tightly packed sediment

When using Purevac Hg with Solmetex Hg5:

- Amalgam Separator is more effective in capturing amalgam
 - Collection container lasts longer
 - Easily see when container is full

Images portray actual in-office results, Argyle Dental Center, London, Ontario, Canada.

INFECTION CONTROL PRODUCTS

Sultan

PUREVAC® Evacuation System Cleaner

Dissolves away the toughest debris to provide optimal suction.

- The number one Evacuation System Cleaner on the market**
- Daily use eliminates the need to clean the trap
- Dissolves: impression materials, bone fragments, organic tissue, rope-like saliva, odor causing debris, and calcium deposits that can build on the evacuation pump.
- Fresh lemon scent
- Concentrated formula 1 oz (30ml) makes 1 quart (1 liter) of solution
- Includes convenient 1 oz (30ml) metered dose pump
- Biodegradable formula

REF 21113 **PUREVAC 2-Liter (67oz) Bottle**
(67 treatments)

REF 21115 **PUREVAC 5-Liter (167oz) Bottle**
(167 treatments)

PUREVAC® AUTO WALKABOUT Dispenser

Easily dispense PUREVAC Evacuation System Cleaner.

- Creates a turbulent mixture of air and PUREVAC solution to effortlessly clean your evacuation system
- Holds enough solution to clean 3 operatories

REF 21116 **AUTO WALKABOUT**

**Strategic Dental Marketing, 2007

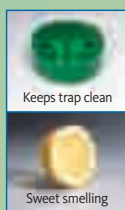

Purevac is proven to be the best cleaner among market leaders.*

% Soil Reduction in Corrugated Tubing Test.

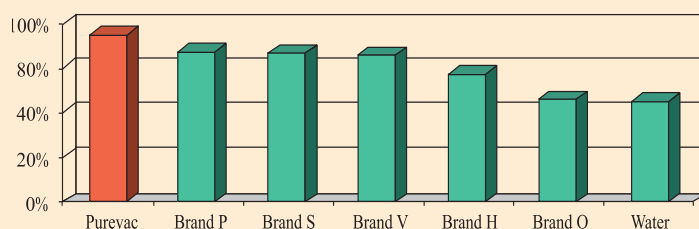

*Independent Evacuation System Cleaner study, 2006.

PUREVAC and PUREVAC Hg: Clean Your Entire Evacuation System From End To End...

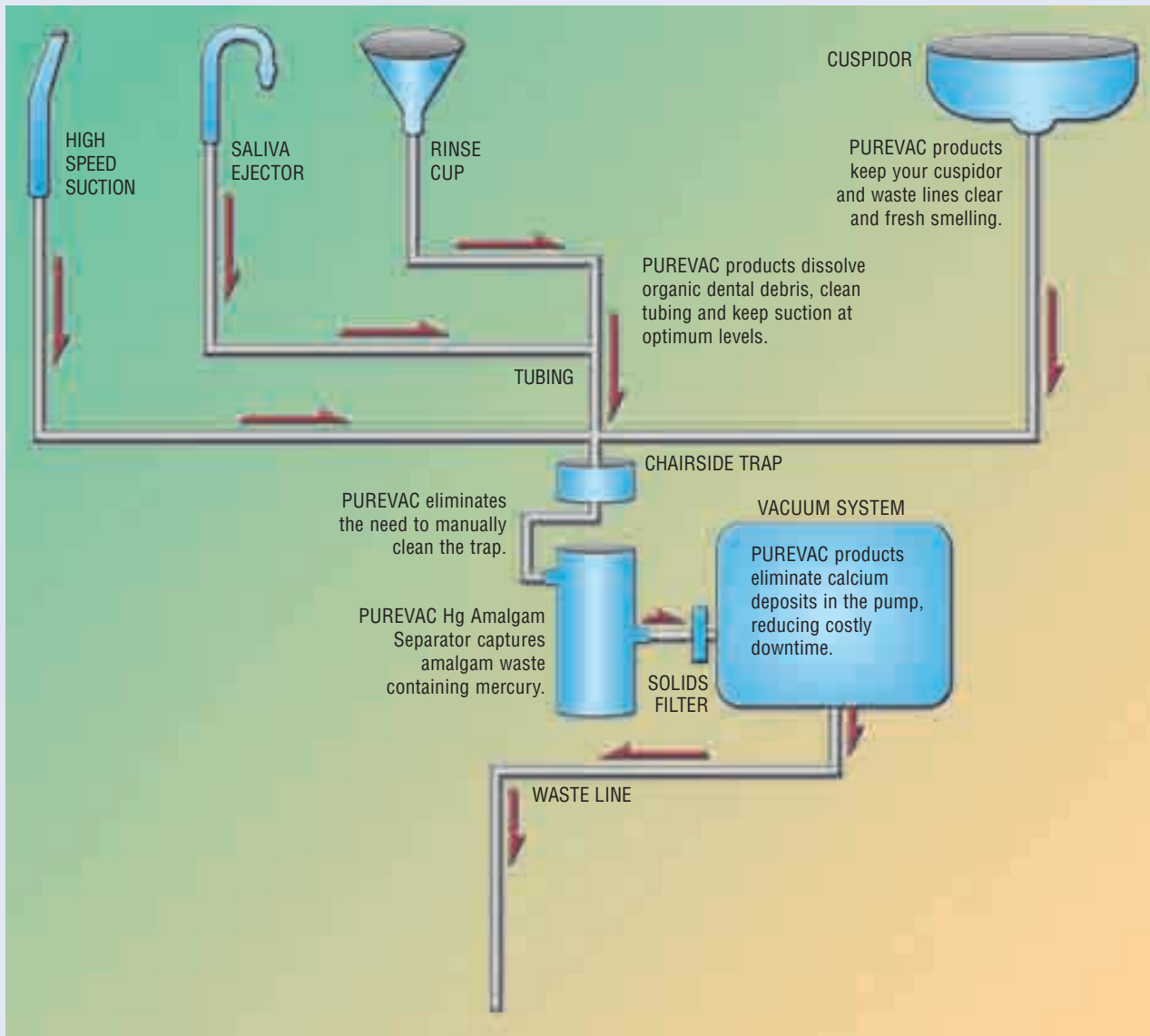

Cleaning with PUREVAC or PUREVAC Hg and the AUTO WALKABOUT is simple!



Step 1: Fill with water and add PUREVAC.



Step 2: Attach saliva ejectors and turn on suction lines.



Step 3: Rinse remaining solution down cuspidors.

INFECTION CONTROL PRODUCTS

Sultan

The all-in-one disinfectant that removes biofilm and deactivates viruses, bacteria, fungi and micro-organisms.

SOLO™ Disinfectant Cleaner. One disinfectant. Multiple uses.

It's here, at last—a single, powerful solution to clean and disinfect virtually anything in your practice. Now, there's no longer any need to store litres upon litres of different cleaning products. SOLO Disinfectant Cleaner can handle it all. It cleans deep—actually deactivating viruses, bacteria, fungi and micro-organisms at the cellular level, without harmful alcohols, aldehydes or phenols.

- **COMPATIBLE and VERSATILE.** Use SOLO Disinfectant Cleaner for medical devices and equipment
- **NO HARMFUL INGREDIENTS.** Contains no alcohols, phenols, aldehydes, chlorines or halogens
- **FAST and EFFECTIVE.** Bactericidal in one minute, tuberculocidal, fungicidal and virucidal in five minutes*
- **DEEP CLEANING.** Penetrates and lifts soils from the surface while deactivating harmful micro-organisms
- **VERY ECONOMICAL.** Concentrated formulations provide low cost-per-use
- **AMAZING DELIVERY and PACKAGING.** Innovative packaging systems save space and are easy to handle and use

REF 90000 SOLO™ Disinfectant Wipes
160 Wipes per package

REF 90010 SOLO™ Squeeze & Fill
Concentrated Spray 120 ml

REF 90015 SOLO™ Squeeze & Pour
Concentrated Disinfectant
Cleaner 1L

REF 90005 SOLO™ Ready-to-Use Disinfectant
Cleaner Spray 750 ml

*According to EN and AOAC standards.



Cleans and deactivates at the cellular level

These still images demonstrate the cleaning and disinfectant capabilities of SOLO Disinfectant Cleaner. The first image is of live E.coli cells prior to the application of SOLO disinfectant spray. The second image was taken 60 seconds after application, and the degradation in cell structure is clearly visible with expelled cell contents dominating the image, proving the disinfectant effect of the SOLO disinfection formula.

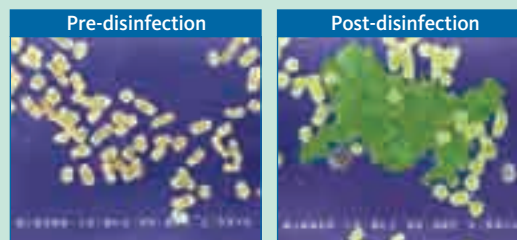

Electron Microscope Images of E.coli bacteria, pre- and post-disinfection with SOLO disinfectant spray. (6,000x magnification)

Effective. Safe. Convenient. SOLO Disinfectant Cleaner is the single disinfecting solution you've been waiting for.



SOLO™ Squeeze & Fill™ Concentrated Spray

- Unique bottle mixes concentrate with water, saving space and money
- Easy to use...simply squeeze one level of concentrate into the reservoir and fill with water!



HUGE SPACE SAVER! Ingenious design turns 120 ml of concentrated solution into eight, 650 ml spray bottles of disinfectant solution.



SOLO™ Squeeze & Pour™ Concentrated Disinfectant Cleaner

- Convenient measure-and-pour bottle makes mixing simple and easy
- Use for soaking instruments, burs and impression materials
- 1 litre bottle makes 50 litres of disinfectant solution!



Squeeze...

fill...

spray!



Squeeze...

pour...

soak!



SOLO™ Disinfectant Wipes

- Simple and convenient cleaning and decontamination
- Viscose cloth wipe is durable and absorbs more liquid solution, providing a wetter surface to ensure product effectiveness
- 13 cm x 19 cm wipes containing SOLO Disinfectant Cleaner



COMPARE! SOLO's Space Saver canister holds 160 wipes, compared to other brands that are larger and hold less.



SOLO™ Ready-to-Use Disinfectant Cleaner Spray Bottle

- Lightweight and ergonomic trigger spray bottle
- Contains 750 ml of disinfectant/cleaner solution
- No Mixing... just point, spray and wipe!

INFECTION CONTROL PRODUCTS

Sultan

LYSOL® I.C.™ Disinfectant Spray

No other disinfectant spray kills more germs and viruses. Why would you use anything else?

- Proven Effectiveness – Kills harmful microorganisms such as Tuberculosis, Poliovirus, HIV-1, Hepatitis A, Herpes Simplex Type 1 and Herpes Simplex Type 2
- Kills 99% of germs on hard, non-porous surfaces in 30 seconds
- CONTROL FLO™ valve – Spray action enhances surface coverage and minimizes airborne particles
- Light Scent – 77% less fragrance than regular LYSOL® Spray. Not overpowering
- Ideal for countertops, door handles, waiting rooms, sick rooms, laboratories, sinks and other hard non-porous surfaces.

REF 95029 19oz (539g) can

LYSOL® I.C.™ Foaming Disinfectant Cleaner

The quick and easy foam cleaner that disinfects.

- Ready to use quaternary formula provides hospital-grade germicidal activity
- Effective against HIV-1 (AIDS virus), Poliovirus Type 1, Staphylococcus, Salmonella, and Pseudomonas on hard nonporous surfaces
- Rich foam lather spreads easily for effective cleaning.
- Contains no harsh acids, abrasives or bleach
- Ideal for fiberglass, porcelain, synthetic marble, tile, plastic and vinyl

REF 95524 24oz (680g) can

LYSOL® I.C.™: The Most Trusted Name In Disinfection

Health care professionals have used LYSOL® I.C.™ disinfectant products for effective protection from germs and viruses since 1889. No matter what your surface disinfection needs may be, trust LYSOL® I.C.™ to protect your patients and your practice.



LYSOL® I.C.™ Brand II Disinfectant Spray demonstrated rapid and thorough kill (greater than 3 log₁₀ reduction) of polio virus 1 (Mahoney) and tuberculosis organism (M. Bovis) in both the absence and presence of body fluids in hundreds of tests conducted by an independent non-profit dental education and product testing foundation. Of 260 disinfectant brands tested by this independent non-profit foundation, only 4 currently passed this clinically relevant testing (and only two are available in the US). A full report is available upon request.

To properly disinfect and clean blood or body fluids, the correct procedure is to:



Step 1: Spray with disinfectant or disinfectant cleaner.



Step 2: Wipe up contaminated fluids.



Step 3: Spray with a surface disinfectant and let air dry.



LYSOL® I.C.™ Quaternary Disinfectant Cleaner

Highly concentrated, cost effective hospital-grade disinfectant.

- Economical, concentrated formula makes up to 256 gallons (969L) at a 1:256 dilution
- Neutral pH in Use
- Virucidal, fungicidal and bactericidal
- Ideal for floors, walls, glazed porcelain, plastic surfaces and other hard non-porous surfaces

REF 74983 1 gallon (3.8L) bottle



Professional AMPHYL® Disinfectant Cleaner Concentrate

Economical Phenolic Based hospital-grade disinfectant.

- Economical, concentrated formula makes up to 200 gallons (757L) at a 1:200 dilution
- pH level of 10.5 in Use
- Tuberculocidal, virucidal, fungicidal and bactericidal
- Ideal for wheelchairs, patient bed frames, bedside tables, medical lamp stands, bathroom fixtures, floors and walls

REF 95101 1 gallon (3.8L) bottle



Professional AMPHYL® Hospital Bulk Disinfectant Cleaner

Economical Phenolic Based hospital-grade disinfectant.

- Sanitizes laundry, linens and blankets
- Economical, concentrated formula makes up to 100 gallons (379) at a 1:100 dilution
- Tuberculocidal, virucidal, fungicidal and bactericidal
- Prevents odors and growth of mold and mildew
- Ideal for laundry, wheelchairs, patient bed frames, bedside tables, medical lamp stands, bathroom fixtures, floors, and walls

REF 92500 1 gallon (3.8L) bottle



Professional AMPHYL® Disinfectant Deodorant Spray

A convenient way to disinfect and deodorize hard, non-porous surfaces.

- Effective disinfectant that kills odor-causing bacteria at their source
- Tuberculocidal, virucidal, fungicidal and bactericidal
- Kills 99% of germs in 30 seconds
- Ideal for countertops, floors, toilet seats, urinals, shower stalls, wheelchairs, stainless steel, walls, sinks and telephones

REF 98300 13oz (369g) can

CDC (Centers for Disease Control) Recommendations

Environmental Surface Cleaning and Disinfection

Clean and disinfect clinical contact surfaces, not barrier protected, by using an EPA registered hospital disinfectant with a low- to intermediate-level activity after each patient. Use an intermediate-level disinfectant if visibly contaminated with blood.

Classification of Disinfectants

- High Level – Sporocidal, Tuberculocidal, Virucidal, Fungicidal, and Bactericidal.
- Intermediate Level – Tuberculocidal, Virucidal, Fungicidal, and Bactericidal.
- Low Level – Virucidal, Fungicidal, and Bactericidal.

INFECTION CONTROL PRODUCTS

Sultan



SURFLETS™ Disinfectant Tablets

Convenient and versatile. Cleans and disinfects hard, non-porous surfaces, instruments and impression materials while saving valuable storage space.

- Provides hospital-grade, Intermediate Level Disinfection in 5 minutes! Effective against: Tuberculosis, Herpes Simplex Virus 1 and 2, Polio Virus 1 and 2, Influenza A2 (Hong Kong), HIV-1 (AIDS Virus), and Canine Parvovirus
- Convenience – No mixing of liquids required, add two tablets (A & B) to 32oz (.95L) bottle and add water

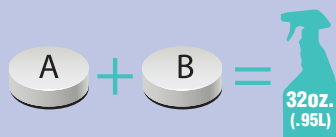

- Saves Space, one box makes 16 quarts (15L) of solution
- Unique blister packaging makes it safe and easy to dispense tablets
- Less mess vs. liquid solutions
- Neutral pH, bromine based formula will not corrode surfaces including chairs or metal instruments
- Contains no alcohol or phenols
- No need to replace solution every day; solution remains effective for seven days after initial dilution
- Versatile for decontamination of multiple areas and surfaces

REF 21510 Box of 16 sets of Tablets

REF 21511 SURFLETS Empty Trigger Spray Bottle 32oz (.95L)



Disinfects Hard Non-porous Surfaces



Disinfects Non-porous Impression Materials such as vinyl polysiloxane, polysulfide and silicon

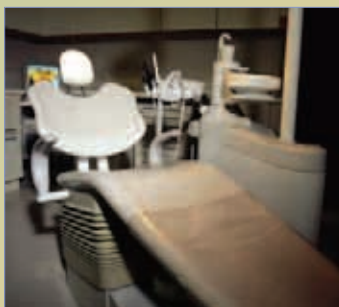

Compatible for dental chairs and exam tables



Pre-soak and disinfect instruments in an ultrasonic cleaner or soaking tray prior to terminal sterilization



SOAPLETS™ Antibacterial Foaming Hand Soap Tablets

A unique, pleasant to use foaming hand soap designed in a convenient tablet format.

- Broad Spectrum Activity – effective against microorganisms such as Staph., Salmonella, Pseudomonas, and E. coli.
- No need to pre-wet hands; foaming consistency removes dirt and oils easy and effectively
- Contains natural jojoba oil to moisturize skin, without harm to latex gloves
- Pleasant Fresh Lemon Fragrance
- Saves Space! – 2 tablets makes 17oz (500ml) of Foaming Soap



- Unique Blister packaging makes it safe and easy to dispense tablets
- Available with 17oz (500ml) Foaming pump bottle

REF 21515 Box of 12 Tablets makes 3.3L (0.9gal) of soap

REF 21516 SOAPLETS Empty Foaming Pump Bottle 17oz (500ml)

GLOVE RELIEF® Moisturizing Hand Cream

Formulated to revitalize dry, chapped skin and facilitate application and removal of gloves.

- Ideal for dry, chapped hands as a result of constant washing and repeated glove use
- Aloe Vera and Vitamin E promote healing and healthy skin growth
- Mineral oil and dimethicone facilitate glove application and removal without harming the integrity of the glove
- Water-based formula absorbs into skin instantly without an oily residue
- Fragrance-free

REF AD31209 3.3oz (94g) tube

INFECTION CONTROL PRODUCTS

Sultan



Antimicrobial Soap:

The #1 hand soap in dental offices throughout the U.S.!

- Gentle on hands, non drying to the skin
- Broad-spectrum antimicrobial activity
- Reduces the risk of cross contamination
- Lathers in both hard and soft water for maximum cleaning under all conditions
- Active ingredient: 0.3% Triclosan™
- Pleasant fragrance

REF 95701 1 Gallon (3.8L)

REF 95717 17.5 oz (517ml) Pump Bottle

TOUCH LESS™

Liquid Soap Dispenser

This safe, clean and convenient soap dispenser ELIMINATES:

Contact with contaminated surfaces
Exposure to germs
Messy wash areas

- Infrared sensor dispenses when detecting the presence of a hand
- Sleek design makes it perfect for wall mounting
- Dispenses 1.0ml per cycle
- Holds 500 ml (16.9 fl oz)
- Powered by 4 AA batteries (not included)

REF 95704 TOUCH LESS Soap Dispenser



Strong Infection Control with a Gentle Touch!

Sultan Healthcare products are ideal for encouraging compliance with protocols that require frequent hand washing.



CDC (Centers for Disease Control) Recommendations

Performing hand hygiene is one of the easiest yet most critical steps in breaking the chain of infection. Hands should be washed in the following instances:

- When hands are visibly soiled
- After barehanded touching of inanimate objects likely to be contaminated by blood, saliva, or respiratory secretions
- Immediately after removing gloves
- Before and after treating each patient
- Before donning gloves



InstaFresh™ Instant Hand Sanitizer

Decontaminates and moisturizes hands to refresh them in between hand washings, keeping you compliant and greatly reducing the risk of cross-infection.

- 70% Ethanol Formulation provides effective decontamination
- Moisturizers leave hands feeling soft & clean
- Dries quickly without residue
- Low viscosity allows for easier, faster coverage
- Meets CDC Requirements for a hand sanitizer

REF 95709 4oz (118ml)

REF 95710 18oz (532ml)

REF 95711 32oz (.95L)

TOUCH LESS™ Sanitizer Dispenser

Safe, clean and convenient dispenser can be placed in areas where soap and water are not accessible.

- No-touch dispensing reduces cross-contamination risk
- Easy pour-in refill, no need for special bags or containers
- Use wall mounted or free standing
- Dispenses 0.5ml at a time
- Holds 1 liter (33.8oz) of solution
- Powered by 2 "C" batteries (included)

REF 95707 TOUCH LESS Sanitizer Dispenser



CDC (Centers for Disease Control) Recommendations

Optimal waterless hand sanitizers have specific product features:

- Ethyl Alcohol is preferred due to greater virucidal activity over isopropyl alcohol
- The alcohol content should be between 60% and 95% for maximum effectiveness
- Emollients to prevent skin dryness
- A well-designed dispenser – that is easy to use, reliable and designed to avoid cross contamination

When it Comes to Face Masks,
We've Got You Covered.

Maximum filtration, greater breathability
and superior comfort, a line of facial
protection to meet the needs of any office!

com-fit™ masks

All COM-FIT™ pleated masks offer:



High Filtration

- 97-99.9% filtration at 0.1 micron, providing protection against bacteria, viruses and other microscopic particles
- Select Com-Fit masks provide added protection against potentially harmful fluids and aerosols



Easy Breathe

- Com-Fit masks keep you cool, allow you to breathe with minimal moisture, and are more comfortable without sacrificing protection

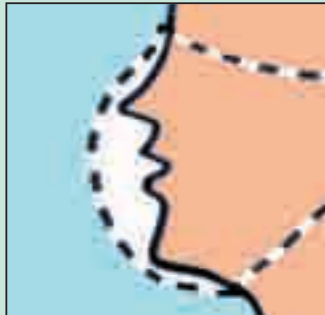

Non-Irritating

- Hypoallergenic and latex-free components will not irritate skin
- Ultra soft, latex-free, ultrasonically bound earloops and ties for your comfort



Soft earloops are ultrasonically bound to the outside of the mask so they won't cause skin irritation



Soft ties are extra long to easily secure and remove your mask especially when wearing head covering



All pleated masks are made in the USA. You can trust the COM-FIT pleated mask worn to protect you is made with the best materials under the stringent quality standards required in USA - not in CHINA.

COM-FIT™ Groovy Mask

- Unique groovy design that you, your staff, and your patients will love
- Keep Germs FAR OUT: 99.6% PFE at 0.1 micron
- Provides highest level of fluid resistance: 160mmHg per ASTM test standard F1862 (the only standard to prove fluid resistance for a face mask)
- Improved breathability over leading fluid resistant masks, keeps you cooler
- Foam strip keeps glasses fog free
- Available in Ear Loop or Ear Loop w/Shield

REF 20350 40/Box
EarLoop
REF 20351 25/Box
EarLoop
w/Shield



★ MADE IN USA





★ MADE IN USA



★ MADE IN USA

COM-FIT™ Super High Filtration Face Mask

- Features two-way DELNET® film barrier* that provides fluid protection with excellent breathability
- 99% PFE at 0.1 micron
- Foam Strip keeps glasses fog free
- Fluid resistant at 80mm/Hg
- Available in Ear Loop or Tie On design
- Available with Anti-Fog face shield

REF 20326 40/Box Ear Loop
REF 20336 40/Box Tie On
REF 20328 25/Box Ear Loop w/Shield



★ MADE IN USA

COM-FIT™ Super Sensitive Face Mask

- Provides excellent protection for those with sensitive skin
- Latex-free with no inks, dyes, perfumes or scratchy surfaces to irritate skin
- Soft, Hypo-allergenic construction
- Provides 99% PFE at 0.1 Micron
- Available in Ear Loop or Tie On design

REF 20346 50/Box Ear Loop
REF 20344 50/Box Tie On



★ MADE IN USA

COM-FIT™ EASYBREATHE™ Face Mask

- Allows you to breathe easier while maintaining a high level of protection
- Up to 250% more breathable than standard masks
- 97% PFE at 0.1 micron
- Available in Ear Loop or Tie On design

REF 20340 40/Box Ear Loop
REF 20342 40/Box Tie On



COM-FIT™ Fluid Resistant Procedural Masks

- Soft comfortable design
- Contains a fluid resistant outer layer, protects at 80mm/Hg
- 99% PFE at 0.1 micron
- Economical
- Available in Ear Loop design

REF 20324 50/Box Ear Loop Blue

REF 20325 50/Box Ear Loop Pink



COM-FIT™ Cone Masks

- Anatomically designed to contour to the face
- Soft rolled edge for facial comfort
- No Metal noseband eliminates nose pinch
- 99% PFE at 4.3 micron
- Available in 2 sizes; Green – large, Pink – Medium

REF 20318 100/Box Green

REF 20319 100/Box Pink



ASEPT-ALL® Safety Glasses (Clear)

- Lightweight, high quality construction
- Excellent protection without visual interference
- One size fits all

REF 20330 Safety Glasses Each



COM-FIT™ Wall Bracket

- Attaches to the wall and holds a box of COM-FIT pleated masks for convenient, easy dispensing

REF 20301

CDC (Centers for Disease Control) Recommendations

It is important to wear a surgical mask and eye protection with solid side shields or a face shield to protect mucous membranes of the eyes, nose, and mouth during procedures likely to generate splashing or spattering of blood or other body fluids. Change masks between patients or during patient treatment if the mask becomes wet.

Proper Mask Usage

Donning a Face Mask

Masks are effective only if worn properly. To maximize your protection, be sure to follow these simple steps.



- ① Cover nose and mouth completely with mask



- ② Ensure mask conforms to the face at the sides of the mouth



- ③ Mold nosepiece to promote a close fit



- ④ Use protective eyewear with side shields when exposure to fluids is possible



- ⑤ DO NOT wear below the nose



- ⑥ DO NOT let hang or dangle around the neck

Removal of a Face Mask

The following tips should be followed when removing a mask:

- A. A mask should be changed between patients and if it becomes wet during patient treatment
- B. Only handle earloops or ties
- C. Promptly Discard Soiled Mask
- D. Wash Hands
- E. DO NOT fold and place in a pocket for later use

Glossary of Mask Terms

PFE: Particle Filtration Efficiency: Measures the percent efficiency at which the facemask filters sub micron particulate from passing through the mask

Fluid Resistance: The ability of a face mask material construction to minimize fluids such as blood, body fluids and aerosols from traveling through the material and potentially come into contact with the user.

The only test standard for fluid resistance is ASTM F 1862. All masks designated "fluid resistant" meet or exceed ASTM F1862 for fluid resistance at 80, 120 or 160. The higher the number the better the fluid resistance.

Breathability – Differential Pressure ΔP : Conveys how easily air passes through a facemask which is an indication of how easily you can breathe while wearing it. The lower the ΔP , the easier the mask is to breathe through.

INFECTION CONTROL PRODUCTS

Sultan

Effective Instrument Reprocessing Using Sultan Healthcare Products

Sultan Healthcare offers a line of products for fast and effective instrument processing. Our products will help you maintain the proper protocols for cleaning and sterilization as recommended by the CDC.

Cleaning

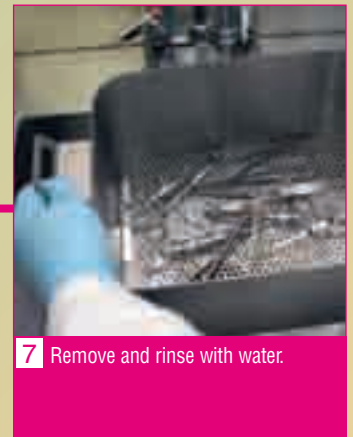
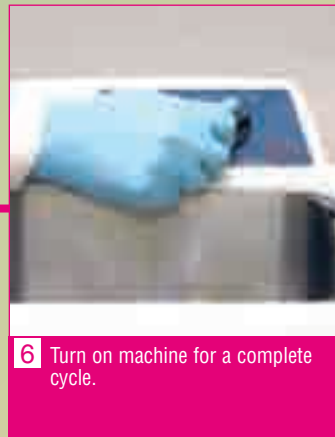
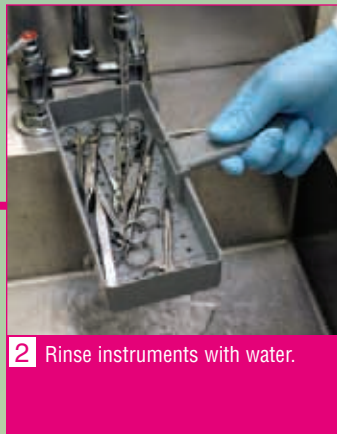
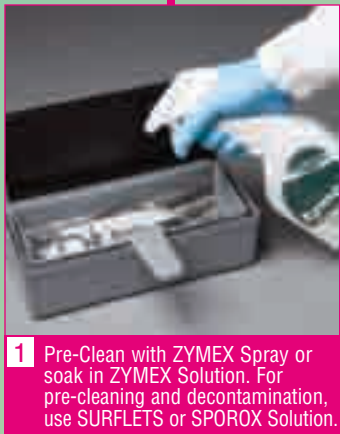

Autoclave Sterilization

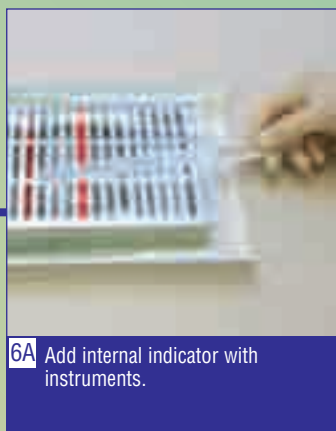

Liquid Sterilization

Recommended for use with heat sensitive instruments that cannot be autoclaved.



CDC (Centers for Disease Control) Recommendations

Designate a central processing area and divide into distinct areas for the following steps:

1. Receiving cleaning and decontamination
2. Preparation and packaging
3. Sterilization
4. Storage

Do not store instruments in an area where contaminated instruments are held and cleaned.

ZymeX™ Enzymatic Cleaners

ZymeX™ is a Family of Enzymatic Cleaning Solutions that are safe and effective in processing all types of medical and dental devices.



ZYMEX Works 3 Times Faster than Leading Brands.

Percentage Organic Load Reduction after 5 Minutes.

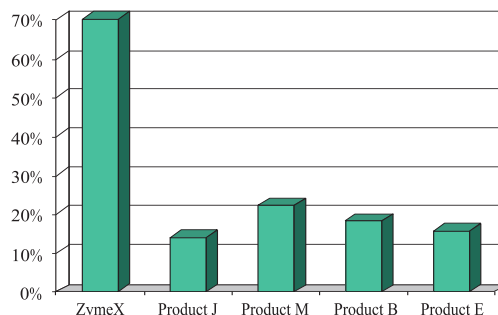

*Source: Independent Enzymatic Cleaner Study 2001.

ZymeX™ Enzymatic Cleaner Concentrate

A patented dual enzyme formulation that breaks down organic debris such as blood, rust and mineral deposits from all types of surgical instruments and scopes. In addition, it will attack protein, carbohydrate and lipid containing soils.

ZymeX™ Concentrate Features:

- Free Rinsing, does not leave a residue
- Breaks down three times more bio burden than the market leaders within five minutes.*
- Low Foaming for use in ultrasonic cleaners, evacuation systems, reprocessing units and washer/sterilizers.
- Contains a special rust inhibitor that prevents corrosion on metal instruments.

- Neutral pH makes it safe to use for almost any medical and dental device.
- Economical, super-concentrated formula. 1 oz (30ml) makes 1 gal (3.8L) of solution

REF 21380	1 Gallon (3.8L)
REF 21381	1 Quart (0.95L)
REF 21384	5 Liter (1.3 gal)
REF 21390	5 Gallon (18.9L)
REF 21383	15 Gallon (56.8L)

*Source: Independent Enzymatic Cleaner Study 2001



ZYMEX Super Foaming Enzymatic Spray
Lasts Almost 3 Times Longer than Leading Brands.
Longevity of Foam in Hours.

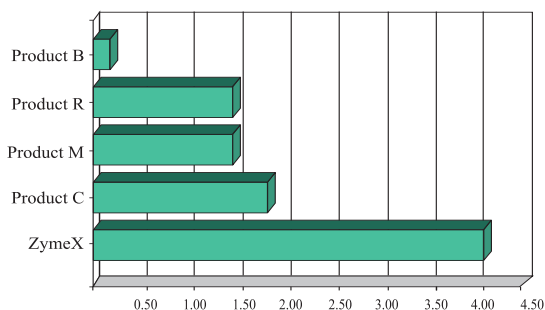

*Source: Independent Foaming Enzymatic Cleaner Study 2004.



Zymex™ Super Foaming Enzymatic Spray

A ready-to-use, dual enzymatic formulation used to pre-clean medical and dental instruments including scopes.

- Long Lasting Foam remains active for over 4 hours to prevent soils from drying

- Dual enzyme formulation breaks down blood and protein soils
- Neutral pH formula is safe for use on plastic, rubber, stainless steel, carbon steel and soft metals
- Effective in a broad range of temperatures

REF 21389 22 oz (660ml)

Sultan

Ultrasonic Cleaning Solutions

For Effective instrument reprocessing, Sultan Healthcare offers a wide range of Ultrasonic Solutions from convenient, compact tablets and liquid packets to more economical gallons.



PRO-PORTION® Ultrasonic Cleaning Solutions

Super-concentrated, super-convenient 1oz (30ml) packets dissolve quickly and easily in your ultrasonic machine. Sparkling clean results with no odor or residue.

PRO-PORTION® General Purpose Cleaning Solution

- Removes blood, tissue, oxides, plaster, pumice, soil, rouges, and buffing compounds from dental instruments and appliances
- It's easy, fast and efficient instrument recirculation — without odor or residue
- Mix one packet per gallon of water (3.8L)

REF 21360 Box of 20 Packets

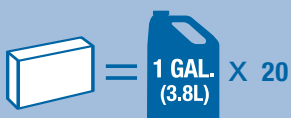

Save space! 1 box makes 20 gallons (76L).

PRO-PORTION® Enzymatic Cleaning Solution

- Patented dual enzymatic reaction to break down protein soils such as blood tissue and mucous
- Use as a pre-soak solution to prevent soils from drying prior to the cleaning process
- Neutral pH formula is safe for your instruments
- Biodegradable, non-toxic with no harsh chemicals
- Mix one packet per gallon of water (3.8L)

REF 21370 Box of 20 Packets

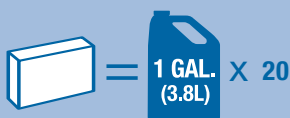

Save space! 1 box makes 20 gallons (76L).

PRO-PORTION® Tartar and Stain Remover

- A concentrated formulation designed to clean stubborn stains from dentures, crowns, and bridges
- Non-toxic, non-corrosive, and non-hazardous
- It's safe for your staff plus it allows you to avoid hazardous material shipping charges
- Mix one packet to 5 ounces of water (148ml).

REF 21375 Box of 20 Packets





CLEANLETS™

Ultrasonic Cleaning Tablets

Every Cleanlets ultrasonic tablet provides quick, effective cleaning in a single dose. Patented technology gives you highly concentrated cleaners that are safe and effortless to use. Effervescent formula makes mixing easy and automatic. Its unique blister packaging makes Cleanlets a snap to dispense.

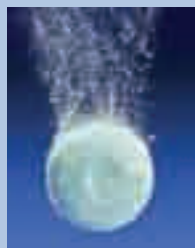

GENERAL PURPOSE:

- 1 tablet makes 1 gallon (3.8L) of solution versus two of the leading brand's tablets
- Excellent cleaning properties last all day, while enzyme cleaners lose effectiveness as the day goes on
- Easily removes common soils such as blood, tissue, plaster, pumice, buffing compounds, etc.
- Fully water soluble, will not leave a residue on instruments or in the tank like enzyme tablets and solutions
- Effective in all water temperatures, hot or cold

REF 21500 Box of 32 Tablets



Save space!
1 box makes
32 gallons
(121L).

TARTAR & STAIN:

- 1 tablet makes 5 oz (148mL)
- Removes calculus, tartar, tobacco and food stains
- Use in an ultrasonic beaker for dentures, bridges and appliances
- No need to use messy liquids or carry bulky containers

REF 21505 Box of 32 Tablets

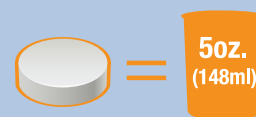

PRO•SONIC™ Ultrasonic Cleaning Solutions

Economical gallon (3.8L) solutions provide effective cleaning.



PRO•SONIC General Purpose Cleaner

- Cleans dried blood, tissue, oxides, buffing compounds, plaster, pumice, soil, rouges, and other debris from instruments, burs, orthodontic appliances, dentures and metals
- Concentrated 1 gallon (3.8L) makes 10 gallons (38L) of solution

REF 21351 1 Gallon (3.8L)

PRO•SONIC Tartar and Stain Remover

- Used to remove tartar and stains from dentures
- Ready to use

REF 21352 1 Gallon (3.8L)

PRO•SONIC Temporary Cement Remover

- Used to remove temporary cement from instruments
- Ready to use

REF 21353 1 Gallon (3.8L)

INFECTION CONTROL PRODUCTS

Sultan

Unique Features of PRO•SONIC Cleaners:

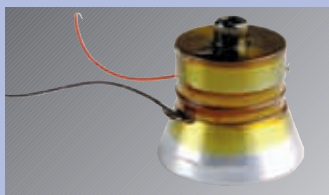

Industrial type ultrasonic stack transducer assures maximum power in the cleaning tank.

PRO•SONIC: Simply the Quietest

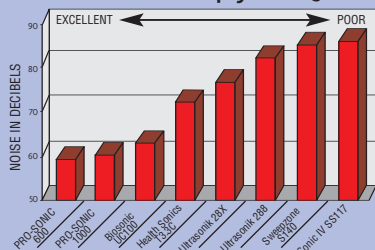

Testing by an independent national laboratory ranked PRO•SONIC cleaners as the quietest.**



PRO•SONIC wide snap-on drain empties tank fast for 600, 1000 and 2000 models.



Above tank controls allow units to be countersunk and protects components from moisture.

PRO•SONIC Full-Size models are backed by one of the best warranties in the industry*:

- 1) Unconditional 60-day return policy
- 2) 2-year warranty on parts and labor
- 3) Lifetime Loaner Program.

*Petite and Assistants carry a 1 year parts and labor warranty

**Reprints available upon request

The Ultra-Flexible PRO•SONIC™ Line of Ultrasonic Cleaners

PRO•SONIC™ Ultrasonic Cleaners provide efficient, effective and economical ultrasonic cleaning in a variety of sizes to fit the needs of any office.



PRO•SONIC 2000

Tank Size:	19.5 x 11.5 x 6 in (49.5 x 29.2 x 15.2 cm)
Overall Size:	24 x 18 x 14.5 in (61 x 45.7 x 36.8 cm)
Tank Capacity:	5.5 gal (20.8 L)



PRO•SONIC Petite:

The smallest available unit for cleaning regular size instruments.

PRO•SONIC PETITE

Tank Size:	12 x 4 x 3 in (30.5 x 10.2 x 7.6 cm)
Overall Size:	13 x 5.5 x 6 in (33 x 14 x 15.2 cm)
Tank Capacity:	0.5 gal (1.9 L)

PRO•SONIC Assistant:

A convenient, cost effective way to clean small instruments chairside such as: burs, rubber dam clamps, root canal instruments, crowns, dentures and temporaries.



PRO•SONIC ASSISTANT

Tank Size:	6.5 x 3.5 x 2.3 in (16.5 x 8.9 x 5.8 cm)
Overall Size:	8.8 x 4.5 x 5 in (22.4 x 11.4 x 12.7 cm)
Tank Capacity:	5 oz (148 mL)



PRO•SONIC 1000

Tank Size: 11.5 x 9.5 x 6 in
(29.2 x 24.1 x 15.2 cm)
Overall Size: 16 x 15.5 x 14.5 in
(40.6 x 39.3 x 36.8 cm)
Tank Capacity: 2.5 gal (9.5 L)



PRO•SONIC 600

Tank Size: 11.5 x 6 x 6 in
(29.2 x 15.2 x 15.2 cm)
Overall Size: 16 x 12 x 14.5 in
(40.6 x 30.5 x 36.8 cm)
Tank Capacity: 1.5 gal (5.71L)



PRO•SONIC 300

Tank Size: 9.5 x 5.5 x 4 in
(24.1 x 14 x 10.2 cm)
Overall Size: 13.5 x 12 x 11.5 in
(34.3 x 30.5 x 29.2 cm)
Tank Capacity: 0.75 gal (2.8 L)

PRO•SONIC Accessories*



Full Safety Basket



Half Safety Baskets



Positioning Covers



Cassette Racks

*Contact your Sultan Healthcare dealer or representative for more information about our available accessories.

Select the PRO•SONIC Cleaner that's right for your office...

PRO•SONIC Models	PRO•SONIC 2000	PRO•SONIC 1000	PRO•SONIC 600	PRO•SONIC 300	PRO•SONIC ASSISTANT
MT 117V	REF 61099	REF 61095	REF 61057	REF 61028	REF 61000
MT 230V	REF 64099	REF 64095	REF 64057	REF 64028	REF 64000
MTH 117V	REF 62099	REF 62095	REF 62057	REF 62028	
MTH 230V	REF 65099	REF 65095	REF 65057	REF 65028	
DTH 117V	REF 63099	REF 63095	REF 63057	REF 63028	
DTH 230V	REF 66099	REF 66095	REF 66057	REF 66028	

PRO•SONIC Petite
MT 61100 - 110V
MT 61200 - 110V Japan
MT 64100 - 230V
MT 64200 - 230V Australia
MT 64300 - 230V UK

MT = Mechanical Timer MTH = Mechanical Timer with Heat DTH = Digital Timer with Heat

INFECTION CONTROL PRODUCTS

Sultan

ASSURE PLUS™ Self Seal Sterilization Pouches

The only sterilization pouch with a built in peel-off internal indicator, as recommended by the CDC.

ASSURE Plus™

Sterilization Pouches

- Unique peel-off indicator
 - Confirms heat penetration inside the pouch
 - No need to purchase secondary indicator strips
 - Affixes to patient file for permanent record of sterilization
 - Meets CDC requirements for placement of an internal indicator in each package
- Dual external heat and gas sterilization indicators
- Certified for a minimum 5 year, post-sterilization life!
- Aqua tinted, see through, four ply film allows to identify instrument set up and determine if sterility is compromised
- Strong, medical grade paper that allows steam and gas penetration.
- Quality seals for added strength and a clean, fiber free peel.
- Easy to open overlap design.
- Wide range of sizes for all indications.



REF Number	Assure Plus Pouches	Quantity per Box
83003	2 3/4" x 10" (70mm x 255mm)	200
83000	3 1/4" x 6 1/2" (83mm x 165mm)	200
83005	3 1/2" x 10" (90mm x 255mm)	200
83075	5 1/2" x 7 1/2" (133mm x 191mm)	200
83010	5 1/2" x 11" (140mm x 280mm)	200
83045	5 1/2" x 13" (140mm x 330mm)	200
83015	7" x 13" (180mm x 330mm)	200
83020	10" x 15" (255mm x 380mm)	200
83080	11" x 16" (279mm x 406mm)	100
83025	12" x 18" (305mm x 457mm)	100

CDC (Centers for Disease Control) Recommendations

During sterilization, use an internal chemical indicator in each package. If the internal indicator cannot be seen from outside the package, also use an external indicator.

The Anatomy of a Better Pouch:

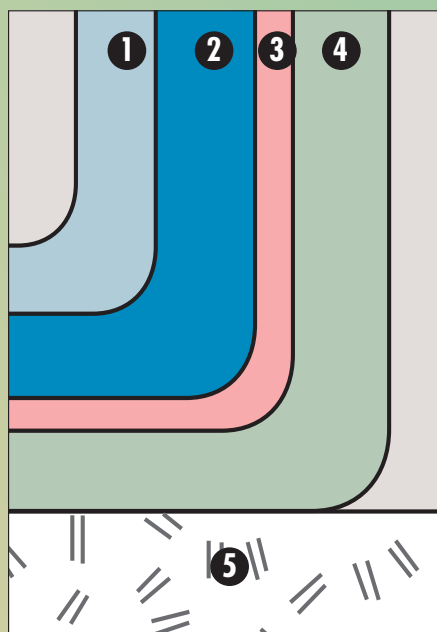

1. A heat-resistant polyester outer layer
2. A structured layer that enhances the toughness and flexibility of the film
3. A polypropylene layer with tear strength properties to eliminate film breakage
4. A new polypropylene sealing layer that eliminates fiber tear
5. A tough, but porous medical grade paper that allows air evacuation and steam/gas penetration



PEELPRO™ Self Seal sterilization Pouches

- Value Priced
- Dual internal and external steam and gas sterilization indicators— meets CDC Guidelines for the use of an internal indicator.
- Double wide seal for excellent puncture protection!
- Medical grade paper allows steam to penetrate and remains strong when wet
- Certified for a minimum 5 year, post-sterilization life!
- Multi layer see through aqua tint film

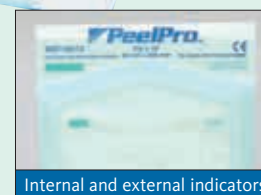

Internal and external indicators

REF Number	Peel Pro Pouches	Quantity per Box
88000	2 3/4" x 10" (70mm x 255mm)	200
88005	3 1/4" x 6 1/2" (83mm x 165mm)	200
88010	3 1/2" x 10" (90mm x 255mm)	200
88015	5 1/4" x 11" (133mm x 280mm)	200
88020	7 1/2" x 13" (190mm x 330mm)	200
88025	12" x 15" (304mm x 380mm)	100

Sterilization Pouch Technique:



Insert Instruments



Peel off ASSURE Plus monitor Strip



Place Monitor Strip into pouch with instruments per CDC recommendations



Color change of monitors inside and outside the pouch indicates processing



Remove strip in front of patient, record name and date



Can be affixed to patient file for permanent record of sterilization

INFECTION CONTROL PRODUCTS

Sultan

SPOROX® II

Sterilizing and Disinfecting Solution

Powerful hydrogen peroxide-based sterilant and high-level disinfectant for heat-sensitive instruments.

- Provides effective infection control without irritating glutaraldehydes
- Ready to Use – No Mixing, heating or activation required
- No noxious odors, safe for your staff
- Oxidizes away dental debris and contaminants quickly and effectively
- Will not bond infectious proteins to instruments like glutaraldehydes
- Sterilization is achieved in 6 hours, high-level disinfection in 30 minutes
- Solution can be re-used for up to 21 days

REF 75156 1 Gallon (3.8L)

Sporox II Test Vials

Tests hydrogen peroxide activity to determine when SPOROX® II solution needs to be changed.

REF 75195 Intro Kit features 30 Vials & 1 Pipettor

REF 75196 Refill Kit features 30 Vials

PRO-SOAK™ Soaking Trays

Convenient for easy instrument processing.

- Removable tray minimizes instrument handling to help prevent sharps injuries
- Made of heavy gauge, high impact plastic
- Available in two sizes

REF 75159 **ProSoak™**
1 Gallon (3.8L) Capacity

REF 75161 **ProSoak™ Jr**
1/2 Gallon (1.9L) Capacity



SPOROX is a safer alternative to glutaraldehydes.

The following statement is published by OSHA (Occupational Safety and Health Administration) in the US, more information can be found at www.osha.gov.

Short term (acute) effects: Contact with glutaraldehyde liquid and vapor can severely irritate the eyes, and at higher concentrations burns the skin. Breathing glutaraldehyde can irritate the nose, throat, and respiratory tract, causing coughing and wheezing, nausea, headaches, drowsiness, nosebleeds, and dizziness.

Long-term (chronic) effects: Glutaraldehyde is a sensitizer. This means some workers will become very sensitive to glutaraldehyde and have strong reactions if they are exposed to even small amounts. Workers may get sudden asthma attacks with difficult breathing, wheezing, coughing, and tightness in the chest. Prolonged exposure can cause a skin allergy and chronic eczema, and afterwards, exposure to small amounts produces severe itching and skin rashes. It has been implicated as a possible cause of occupational asthma.



US Thread		1-SHOT Disposable Dental Needles		
REF	GAUGE	LENGTH	COLOR	QTY/BOX
23000	25-Gauge Short	21mm	Red	100/box
23005	25-Gauge Long	32mm	Red	100/box
23010	27-Gauge Short	21mm	Yellow	100/box
23015	27-Gauge Long	32mm	Yellow	100/box
23020	30-Gauge X-Short	11mm	Blue	100/box
23025	30-Gauge Short	21mm	Blue	100/box

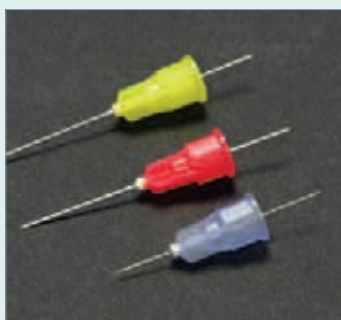

Color coded hubs



Tri-Bevel needle tip

1-SHOT™ Disposable Dental Needles

Provides high-quality, consistency, safety and improved patient comfort at a low cost.

- Super-sharp, tri-beveled needle tips with lancet point insure injection control and patient comfort
- Color-coding at the hub, not the cap, for easy identification at all times
- Available in three different gauges: 25, 27 and 30
- Available in multiple lengths: long, short and x-short
- Pre-threaded at the hub, which eliminates the need for metal hubs
- Full-length threads avoid stripping and eliminates loose needles
- Surgical-grade, siliconized stainless steel cannulas for smooth atraumatic penetration
- Ethylene oxide gas sterilized and sealed with tamper-evident labels



Disposable Air/Water Syringe Tips

- Sealed separation of air and water to prevent water contamination of dry air when dry tooth preparation is required
- Locking bayonet ring prevents accidental ejection of the tip
- Sturdy design allows for full cheek and tongue retraction yet smooth and rounded for patient comfort and safety
- Disposable reducing the risk of cross infection vs. metal tips which are difficult and time consuming to clean and sterilize
- Full tip rotation with 360° swivel converter and angled tip allows to access difficult to reach tooth positions
- Converters available to adapt your current air/water syringe

REF AD38001 Package of 250 Tips
REF AD38005 Box of 1500 Tips

ProSyringe

- Air water syringe that is directly compatible with ProTip Ultra Tips
- Well balanced, smooth, ergonomic design
- Groove on outer sleeve assures doctor that syringe tip is locked in place
- Rotating outer sleeve for easier syringe tip positioning
- Removable valves for easy maintenance

REF AD38010 ProSyringe

PRO-TIP® Ultra Disposable Air / Water Syringe Tips

A uniquely designed disposable air water syringe tip that protects your patients and ensures you get air and water when needed. Using PRO-TIP Ultra Disposable tips instead of metal tips improves patient safety by eliminating the concerns of cross contamination and build-up in metal tips. In addition there is improved office efficiency by eliminating the cost and time to sterilize metal tips.



Align the notch on the tip and converter to confirm tip is locked into place.

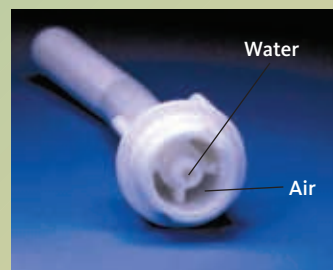

Separate channels of air and water ensures no blow by.



Sturdy for Cheek Retraction.



PRO TIP® Ultra Converters

In minutes, convert almost any syringe to use with the PRO-TIP® Ultra.



ADEC REF AD38020



Castellini REF AD38015



Castellini 109 REF AD38065

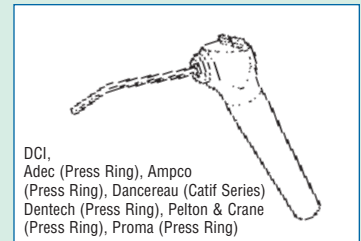

DCI REF AD38050

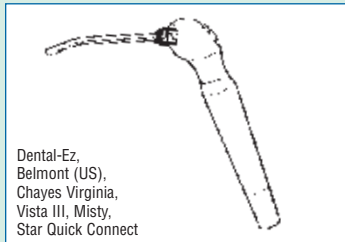

Dental-Ez REF AD38040

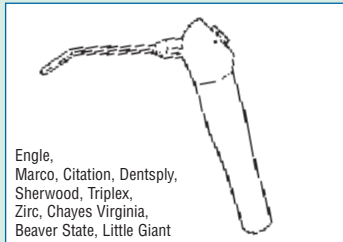

Engle REF AD38030



F-1 125 REF AD38067



Gnatus 134 Converter AD38085FG



Kavo 101 REF AD38035



Kavo 103 REF AD38075

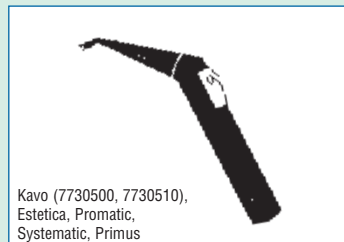

Kavo 138 REF AD38025



Kavo 139 REF AD38080

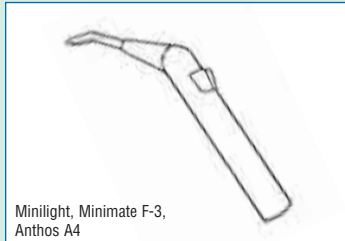

Luzzani REF AD38055



Luzzani 142 REF AD38057



Morita 121 REF AD38090



Morita 140 REF AD38091

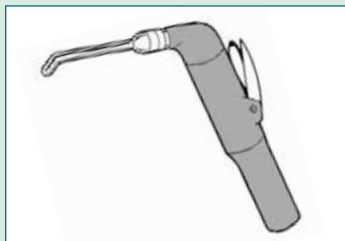

Morita 141 REF AD38092



Ritter 115 REF AD38056

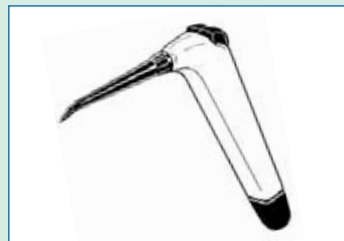

Siemens Sprayvit 4000 REF AD38070



Sirona REF AD38045

Check with your Sultan Healthcare representative for additional converters.

Installing a Converter (using an ADEC style syringe)



Remove Metal Tip



Using a screwdriver, unscrew
existing syringe nozzle or converter



Screw the ProTip Converter
on to the syringe body



Tighten with a screwdriver



Install Tip and test
air and water flow

Preventive Dentistry

Sultan Healthcare has a complete line of Professional and Home Care products to keep your patient's teeth and body healthy. We offer the largest selection of styles and flavors to help keep patients compliant.





Disposable Prophyl Angles

Topex[®]

Prophylaxis Pastes

Topex[®] 00:60[™] SECOND

In-Office Fluoride Gels

Topex[®]

Disposable Fluoride Trays

DuraShield[®] 

5% Sodium Fluoride Varnish

Topex[®]

Take Home Care Fluoride Gels

Guide to Oral Care

Preventive oral care is more than a prophylaxis and polishing - recent research is showing that good oral health could improve overall health! Regular visits to the dentist or dental hygienist, along with good oral hygiene, might have far-reaching benefits beyond the mouth.

Sultan Healthcare recognizes the dental professional as the Prevention Specialist of the oral healthcare team and is committed to providing effective and patient-pleasing products for both in-office and home use — better care for better health! This product guide outlines how Sultan Healthcare's wide variety of products can be used for many different types of patients. The dentist or hygienist can choose the appropriate products for each patient based on needs and preferences. Plus, dispensing take-home products to complement in-office treatments will help provide around-the-clock, 24/7 protection!



PREVENTIVE CARE GUIDE

PATIENTS	PROFESSIONAL APPLICATION	AT HOME APPLICATION
Caries (Prevention, Rampant, Recurrent) Patients with rampant or recurring caries need to remineralize tooth structure to prevent further decay.	Topex APF Fluoride Gel Topex APF Fluoride Foam Topex Neutral pH Fluoride Gel Topex Neutral pH Fluoride Foam (for patients w/ceramic restorations) DuraShield 5% Sodium Fluoride Varnish	Topex Take Home Care® 0.4% Stannous Fluoride Gel Topex Take Home Care® 1.1% Neutral Sodium Fluoride Gel with dentifrice
Perio Recession and sensitivity are general concerns for a perio patient. (For deep debridement procedures choose one of the Topex Topical Anesthetics.)	Topex APF Fluoride Gel Topex APF Fluoride Foam Topex Neutral pH Fluoride Gel Topex Neutral pH Fluoride Foam (for patients w/ceramic restorations) DuraShield 5% Sodium Fluoride Varnish 2 Part In-Office Rinse (2 Minute Swish)	Topex Take Home Care® 0.4% Stannous Fluoride Gel Topex Take Home Care® 1.1% Neutral Sodium Fluoride Gel with dentifrice
Sensitivity Possible sensitivity following prophylaxis or other procedures is common and treatable in the office and at home. For sensitivity during instrumentation, choose one of the Topex topical anesthetics.	Topex APF Fluoride Gel Topex APF Fluoride Foam Topex Neutral pH Fluoride Gel Topex Neutral pH Fluoride Foam (for patients w/ceramic restorations) DuraShield 5% Sodium Fluoride Varnish	Topex Take Home Care® 0.4% Stannous Fluoride Gel Topex Take Home Care® 1.1% Neutral Sodium Fluoride Gel with dentifrice WhiteCare™ Post Whitening Desensitizer (1.1% Neutral Sodium Gel)
Root Exposed cementum is a concern and can cause sensitivity and root caries. A fluoride application and maintenance plan will alleviate the problem.	Topex APF Fluoride Gel Topex Neutral pH Fluoride Gel (for patients w/ ceramic restorations) DuraShield 5% Sodium Fluoride Varnish 2 Part In-Office Rinse (2 Minute Swish)	Topex Take Home Care® 0.4% Stannous Fluoride Gel Topex Take Home Care® 1.1% Neutral Sodium Fluoride Gel with dentifrice
Ortho Decalcification and decay are concerns once orthodontic appliances are attached. Fluoride application will ensure good oral health.	Topex APF Fluoride Foam Topex Neutral pH Fluoride Foam (for patients w/ceramic restorations) DuraShield 5% Sodium Fluoride Varnish 2 Part In-Office Rinse (2 Minute Swish)	Topex Take Home Care® 0.4% Stannous Fluoride Gel Topex Take Home Care® 1.1% Neutral Sodium Fluoride Gel with dentifrice
Cosmetic Esthetic restorations require special care to maintain their luster. Neutral fluoride products will prevent decay while keeping veneers and crowns beautiful.	Topex Neutral pH Fluoride Gel Topex Neutral pH Fluoride Foam (for patients with ceramic restorations) 2 Part In-Office Rinse (2 Minute Swish)	Topex Take Home Care® 1.1% Neutral Sodium Fluoride Gel with dentifrice WhiteCare Post Whitening Desensitizer (1.1% Neutral Sodium Gel)
Dry Mouth Xerostomia can lead to an increased susceptibility to carious lesions. A regular fluoride treatment program both professional and at home can help prevent rampant decay.	Topex APF Fluoride Gel Topex Neutral pH Fluoride Gel (for patients with ceramic restorations) 2 Part In-Office Rinse (2 Minute Swish)	Topex Take Home Care® 0.4% Stannous Fluoride Gel Topex Take Home Care® 1.1% Neutral Sodium Fluoride Gel with dentifrice

Sultan

Topex®

Topical Anesthetic Gels

Topex is the world's best-selling, fast acting Topical Anesthetic. It can also be used to comfort patients with ulcers, wounds and other minor mouth irritations and eliminates the gag reflex when performing radiographs, periodontal, and prosthetic impressions.

Topex® Topical Anesthetic features:

- No bitter aftertaste, prevents excessive salivation and stays active with minimal wash away
- Quick on-set, delivers maximum strength 20% Benzocaine for fast, temporary pain relief
- Excellent for use in many procedures:
 - Local anesthetic injections
 - Periodontal curettage
 - Impression taking
 - Intra-oral radiographs
 - scaling • root planing • prophylaxis

1oz (30ml) Gel

- REF AD31001 Cherry
- REF AD31002 Mint
- REF AD31003 Banana
- REF AD31004 Pina Colada
- REF AD31005 Bubble-Num
- REF AD31006 Strawberry
- REF AD31007 Razzberry

100g Gel

- REF AD31064 Cherry
- REF AD31065 Mint
- REF AD31067 Pina Colada
- REF AD31068 Bubble-Num

1oz (30ml) Liquid

- REF AD31011 Cherry
- REF AD31012 Mint
- REF AD31014 Pina Colada
- REF AD31071 Liquid Dispenser



Topex® Topical Anesthetic Gels

Topex® 20% Benzocaine Topical Anesthetics:
Flavor technology and maximum strength pain relief.



Topical Anesthetic Technique:

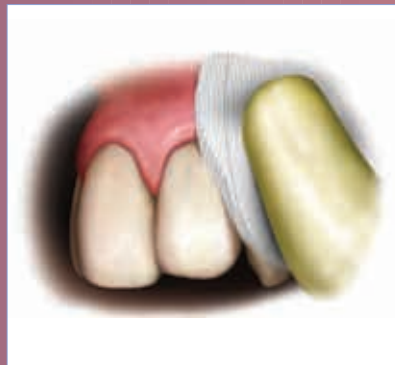

Take sterile gauze and gently wipe and dry the area of the mucosa where the topical anesthetic will be applied.



Place a small amount of the topical anesthetic on a sterile swab.

HandiCaine Stix

Topex® HandiCaine Stix

Topex® Handicaine Stix™ Unit Dose Topical Anesthetic features:

- Single use, hygienically sealed package, aids in asepsis, is ideal for use with a set-up tray and same-patient re-use with no risk of cross-contamination
- Pre-measured dose of .40gm topical anesthetic, provides enough gel for duration of patient's visit



- Ideal size for post treatment take-home care, extending post-treatment patient comfort
- No bitter aftertaste, prevents excessive salivation and stays active with minimal wash away

REF AD31023	Cherry (Box of 24)
REF AD31024	Cherry (Box of 120)
REF AD31025	Pina Colada (Box of 24)
REF AD31026	Pina Colada (Box of 120)

Topex® Metered Spray

Topex® Topical Anesthetic Metered Spray features:

- Metered spray dispensing system, delivers 6mg of anesthetic, eliminating chance of over spray
- 20% Benzocaine, delivers fast maximum strength pain relief, ideal for deep scaling and gag relief
- About 1,000 sprays per can, only pennies per application
- Non-clogging disposable tips, eliminates cross contamination

REF AD31000	Wild Cherry 2oz (60ml), 25 straws
REF AD30999	Disposable Metered Spray Dispensing Tips 200/pkg



Apply the loaded cotton swab to the area to be anesthetized. After application allow to penetrate for 45-60 seconds (gel) and 10-20 seconds (liquid or spray), before injection, x-ray or procedure.

Sultan



Disposable Propphy Angle

Independent testing has proven that Upgrade's beveled gear design "...outperformed all other disposable prophy angles with respect to ease of use"*

Upgrade® Disposable Propphy Angles feature:

- Chatter free & smooth running, steady performance with reduced hand fatigue
- Compact ergonomic design, provides easy access and visibility
- Non-slip Grip, enhances tactile sense
- Exclusive web & ribbed Propphy cup, controls splatter & easily flares uniformly for subgingival access
- Non-latex & odor free, eliminates allergies and sensitivity

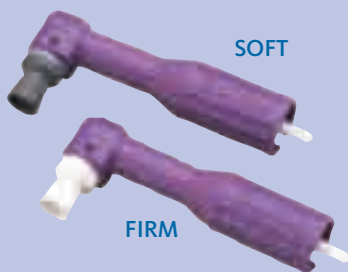

- REF AD30100 Upgrade Firm Cup Pkg 100
 REF AD30101 Upgrade Soft Cup Pkg 100
 REF AD30502 Upgrade Soft Cup Pkg 1200
 REF AD30503 Upgrade Firm Cup Pkg 1200

Upgrade® Disposable Propphy Angle

Upgrade® Disposable Propphy Angle is designed to run longer and smoother with less chatter, providing improved comfort and less hand fatigue than traditional angles.



Beveled Gearing

Upgrade uses beveled gears designed specifically for angle applications. Because the gears share a common pitch there is no speed fluctuation when the gears are engaged. Resulting in:

- Less noise
- Less vibration
- Less heat
- Longer Life

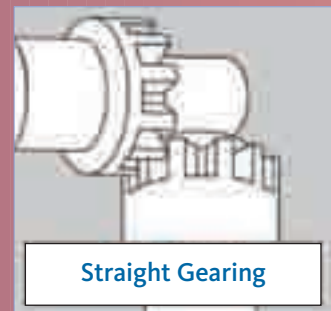

Straight Gearing

Straight gears have pitch lines that intersect, leaving space between gears. During each revolution this space causes a fluctuation in cup speed. Resulting in:

- Vibration
- Noise
- Heat
- Latex Cups may produce odor



Topex® Prophylaxis Paste Unit Dose Cups (200 cups/box)

Coarse	Medium	Fine	Flavor
REF AD30001	REF AD30011		Cherry
REF AD30002	REF AD30012	REF AD30041	Mint (available in extra coarse)
REF AD30004	REF AD30014		Pina Colada
REF AD30007	REF AD30017		Chocolate Mint
REF AD30000	REF AD30015		Assorted (Cherry, Mint, & Pina Colada)
REF AD30008	REF AD30018		Fun Pak™ (Really Raspberry™, Root Beer Float™, & Cinnamint™)
REF AD30009	REF AD30019	REF AD30029	Neapolitan™ Assortment (Chocolate, Vanilla, & Strawberry)
		REF AD30025	Bubble Gum
REF AD60002			Non-Fluoride Mint
	REF AD60011		Non-Fluoride Cherry

Topex® Prophylaxis Paste 12oz Jars

Coarse	Medium	Flavor
REF AD30021	REF AD30031	Cherry
REF AD30022	REF AD30032	Mint
REF AD30024	REF AD30034	Pina Colada
	REF AD30040	Non-fluoride Mint



Topex® Prophylaxis Paste

Topex® prophyl paste combines the perfect blend of polishing and cleaning agents with a 1.23% Fluoride Ion.

- Splatter-free formula, stays on proph cup and tooth surface with no mess
- Excellent washability, leaves no gritty residue
- Disposable unit dose cup, eliminates cross contamination
- Color-coded tops and easy to read labels, are convenient and simple to use
- Great Topex taste in 11 delicious flavors



Disclosing Solution

Used to reveal presence of plaque on teeth. Applied topically or used as a rinse.

REF 10402 2oz (60ml)
REF 10403 16oz (473ml)

Prophylaxis Paste Technique:



Perform dental exam, scaling calculus from above the gum line and subgingivally, followed by flossing. Choose flavor and grit of prophyl paste to use on patient.



Place prophyl paste cup in prophyl ring and attach Upgrade® Disposable Prophyl Angle to low-speed hand piece. Dip prophyl angle into paste and apply to patient's teeth.



With light pressure and circular motion, clean and polish tooth. Continue until both arches are cleaned. Once complete allow patient to rinse with water and expectorate.

*Holt, Williams, Keselyak. A Comparison of Disposable Prophylaxis Angles. The Journal of Practical Hygiene 2003; 12 (2): 23-26.

Sultan

Topex® In-Office Fluorides in Great-Tasting Flavors

Fluoride is a critical component in the fight against cavities; it increases the resistance of teeth to acid demineralization and impedes the function of germs in plaque biofilm.



Topex® APF Fluoride Gels

- Thixotropic formula liquifies when tray is placed on teeth and returns to gel once the tray is seated, reducing gagging and ingestion
- 60 Second application, fast and easy with better patient compliance
- pH between 3 and 4, enhances fluoride uptake in the enamel
- Approximately 100 applications per bottle

16 fl. oz. (480ml) bottle

REF AD31111 Wild Cherry
REF AD31112 Mint
REF AD31114 Pina Colada
REF AD31115 Bubble Fun
REF AD31117 Orange Cream



Topex® Neutral pH Fluoride Gels and Foam

- 2% Sodium Fluoride (0.9% fluoride ion) pH balance of (6.5 - 7.5), ideal for patients with cosmetic restorations or intolerance to acidic fluoride
- Four minute application, for optimal fluoride uptake
- Clearly Strawberry™ Gel contains no dyes, ideal for use after whitening procedures and patients intolerant of colors/dyes

16 fl. oz. (480ml) bottle

REF AD31130 Mint
REF AD31131 Pina Colada
REF AD31132 Clearly Strawberry

4.4oz. (132ml) bottle

REF AD31165 Mixed Berry Foam



Topex® APF Fluoride Foams

- Dense foam consistency, remains in tray under bite pressure, eliminating gagging and ingestion
- 1.23% APF with a 3.5 pH (12,300 ppm), enhances fluoride uptake in the enamel
- Approximately 110 applications, very economical, only pennies per application

4.4oz. (132ml) bottle

REF AD31150 Strawberry
REF AD31151 Spearmint
REF AD31152 Bubble Fun
REF AD31153 Grape
REF AD31154 Orange Dream

Professional Fluoride Treatment Technique:



Select the proper size Topex Disposable Fluoride Tray for your patient.



Seat tray in patient's mouth to check for proper fit (especially around posterior teeth).



Fill each arch with APF Fluoride Gel, Foam, or Neutral (approximately 2 to 3ml) depending on size of tray.



Place loaded tray into patient's mouth and have them bite down for one to four minutes.

Topex® Disposable Fluoride Trays

Topex® Disposable Dual-Arch Fluoride Trays (50 trays/pkg)

- Detailed occlusal anatomy on the biting surface forces gel to contact interproximal regions for total vertical coverage
- Deep distal dam prevents fluoride overflow, eliminates gagging and ingestion
- Locking handle, trouble-free placement and removal
- 4 color coded accurate sizes, easy identification for all your patient's needs

REF AD32010 Pedo (aqua)
REF AD32012 Medium (white)
REF AD32011 Small (yellow)
REF AD32013 Large (blue)



Topex® Disposable Single-Arch Fluoride Trays (100/pkg - 50 Upper/white & 50 Lower/blue)

- Detailed occlusal anatomy on the biting surface which forces gel to contact interproximal regions for total vertical coverage
- Color coded with arch ID, white upper tray includes 'U' on handle, blue lower trays include 'L' on handle, easy identification and placement
- Deep distal dam prevents fluoride overflow, eliminates gagging and ingestion

REF AD32101 Small
REF AD32102 Medium
REF AD32103 Large

Dual-Arch Soft-Lined Fluoride Trays (100 trays/pkg)

- Soft outer shell is comfortable for the patient, will not cut soft gingiva
- Foam lining holds non-thixotropic fluoride gel minimizing gagging and ingestion during application
- Inter-locking handle provides easy placement and removal

REF AD32017 Small
REF AD32018 Medium
REF AD32019 Large



Sultan

DuraShield®

5% Sodium Fluoride Varnish

DuraShield fluoride varnish has several advantages over traditional fluoride treatments with speed, ease of use and range of application. With DuraShield there is no need for a prophy before application. It sets on contact with saliva and releases fluoride for 6-8 hours. There is very little ingestion of fluoride, unlike traditional tray applications. DuraShield fluoride varnish can be safely applied to small children (infants/toddlers), disabled patients and patients with active gag reflex with minimal effort. The light amber color lets you know the tooth surface is completely covered without compromise of esthetics (refer to image below) and will be removed during regular tooth brushing the following morning.

- Each unit dose 0.4ml pack allows you to mix varnish prior to application guaranteeing a consistent level of fluoride in every application
- Relieves hypersensitivity on high risk caries patients with root caries or xerostomia and where dentin or cementum is exposed
- Sets on contact with saliva, remains on tooth for six to eight hours for optimum fluoride uptake
- Single-use, hygienically sealed package, aids in asepsis and eliminates cross contamination making preparation and cleanup fast and simple
- Bubble Fun® flavor and minimal food/drink restrictions after application, increases patient acceptance
- Light amber color, enhances visual control

REF AD31101 DuraShield 5% Sodium Fluoride Varnish, Bubble Fun 32/box

REF AD31102 DuraShield 5% Sodium Fluoride Varnish, Bubble Fun 200/box



Exclusively packaged with
UltraBrush™ 2.0 Bristle Brush Applicator

DuraShield Fluoride Varnish Technique:



Open DuraShield unit dose and blend varnish to a unified color before application. Prophylaxis is not necessary prior to fluoride varnish application.

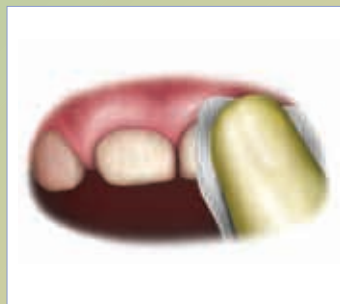

Apply a thin layer of petroleum jelly or lip balm to patient's lips. Dry tooth area to be treated - drying should not be excessive as varnish sets with intraoral moisture.



Apply a thin layer of DuraShield (0.5mm thick) to all surfaces, including molars. Dry and paint until all teeth are treated. Use dental floss to ensure varnish reaches interproximal areas.



Replace all brackets/ortho appliances. Children may have a drink of water immediately following the procedure. Advise patient to eat soft foods and not to brush until the next morning.



Topex® Take Home Care® 0.4% Stannous Fluoride Gel

- 0.4% Stannous Fluoride reduces sensitivity and plaque biofilm while inhibiting cariogenic microbial process
- Thick, clear gel can be easily applied using toothbrush or fluoride tray
- Non-water soluble (stannous), no food or drink restrictions after application
- Alcohol-free with no color additives, reduces allergic reactions

REF AD30210 Bubble Gum 4.3oz. (129ml) (12/box)
REF AD30211 Berry 4.3oz. (129ml) (12/box)
REF AD30212 Mint 4.3oz. (129ml) (12/box)



Topex® Take Home Care® 1.1% Neutral Sodium Fluoride Gel

- Reduces sensitivity and arrests root caries and early, rampant and recurrent decay at crown/margins
- Ideal for patients intolerant of acidic fluoride due to xerostomia, bulimia, radiation, systemic disease, chemotherapy and tooth whitening
- Gentle on bridges, crowns, composites and other aesthetic restorations
- Dentifrice can be used in place of regular toothpaste
- Contains Xylitol, a proven inhibitor of plaque biofilm formation

REF AD30220 Cool Mint 2 oz. (60ml) (12/box)



Topex® White Care™ Post-Whitening Desensitizer

- A 1.1% neutral Sodium Fluoride that contains no color additives
- Ideal for treating hypersensitivity after whitening procedures and for patients intolerant of colors/dyes
- Gentle dentifrice can be used in place of regular toothpaste
- Arrests root caries and early, rampant and recurrent decay at crown/margins
- Contains Xylitol, a proven inhibitor of plaque biofilm formation

REF AD30221 Soothing Raspberry 2oz. (60ml) (12/box)

Since the original Sultan Pharmacy opened in 1872, we have been famous for quality dental therapeutics formulated to improve treatment, healing and pain management.



Root Canal Irrigation

When it comes to removing debris from the root canal, we have you covered.

Sodium Hypochlorite

Quality controlled formula used to flush debris from root canal. Excellent for disinfecting gutta percha. 5.25% solution.

REF 11507

16oz (473ml)



Calcium Hydroxide Powder U.S.P.

Mixed into paste as a dressing for apexification procedures, direct and indirect pulp capping and as a sub-base under restorations.

REF 10301

2oz (57gm)



TECHNIQUE*



① Tooth requiring endodontic therapy.

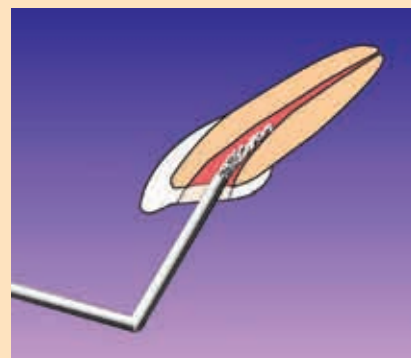

② Instrument the canal with instruments of choice, liberally rinsing with Sodium Hypochlorite between instruments or whenever needed.

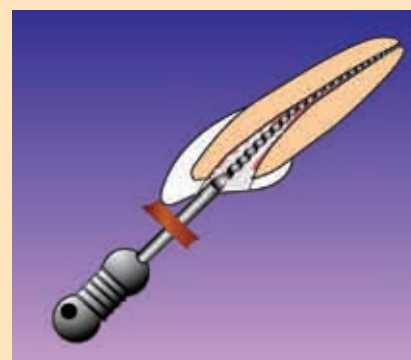

③ Final shaping of the canal space.

*Product technique images in this catalog are for illustrative purposes only. Products should be used in a manner consistent with the operator's training using sound professional judgment and recognized standards of care.

Devitalizers and Disinfectants

Our root canal devitalizers and disinfectants are a reliable way of treating infections and properly disinfecting the root canal.

Camphorated Parachlorophenol U.S.P.

(35% parachlorophenol 65% camphor)

For disinfecting root canals and treating periapical infections. Often used when canal contains necrotic tissue. Virtually non-irritating to periapical tissue. Effective in controlling secondary infections.

REF 10302

1oz (30ml)



Formo Cresol

(48.5% formaldehyde, 48.5% cresol, 3% glycerine)

Powerful pulp devitalizer and disinfectant for severely infected root canals.

REF 10601

1oz (30ml)



TECHNIQUE



If a canal disinfectant is indicated, very slightly moisten a cotton pellet with Formo Cresol or other Sultan Healthcare disinfectant and place into the pulp chamber. Seal the chamber with a

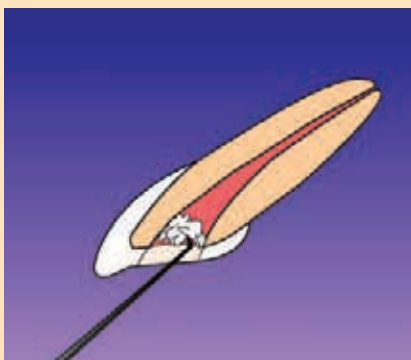

temporary filling material and monitor the progress in a few days. Note: Liquid disinfectants should not be directly introduced into the pulp chamber or canal spaces.

MCP Root Canal Dressing

(25% metacresylacetate, 25% parachlorophenol, 50% camphor) For disinfecting root canals, treating periapical infections and preventing secondary infections. Non-irritating to periapical tissue. Fungicidal and penetrates dentin well. Should be sealed into canal for 48 hours. Contains no formaldehyde.

REF 11101

1/2oz (15ml)



Metacresylacetate (Cresatin)

Perfect for disinfecting root canals, treating periapical infections and pulpotomies involving vital tissue. Won't irritate periapical tissue.

REF 11103

1/2oz (15ml)



Buckley's Formo Cresol

(19% formaldehyde, 35% cresol, 17.5% glycerin) A strong, yet gentle way to devitalize and sterilize infected pulp chambers and canals. It's slightly less irritating to periapical tissue than Formo Cresol due to a lower formaldehyde content.

REF 10203

1oz (30ml)



U/P Root Canal Sealer/Cement Grossman Formula



(Powder: 42% zinc oxide, 27% staybelite resin, 15% bismuth subcarbonate, 15% barium sulfate, 1% sodium borate anhydrous; Liquid: ally gualacol)
Radiopaque, non-staining, non-irritating with excellent thermal insulation.
Features an extended working time and excellent lubricating qualities.
Available in pre-measured capsules that eliminate waste and insure the correct quantity for filling or economical bulk powder. Ideal for use with thermal plastic gutta percha systems.

REF 11612	Medium Set	30 Capsules 1/8oz (3.7ml) Liquid ea.
REF 11613	Economy Set	100 Capsules 1/2oz (15ml) Liquid ea.
REF 11615	Small Bulk Set	1/2oz Powder - 1/4oz (7.5ml) Liquid ea.
REF 11427	30 Capsules	
REF 11428	100 Capsules	
REF 11430	1/2oz (15gm) powder	
REF 11431	2oz (57gm) powder	
REF 11435	1/8oz (3.5ml) liquid	
REF 11437	1/2oz (15ml) liquid	

TECHNIQUE

When the tooth is ready for filling, thoroughly dry the canal with paper points. Mix U/P cement as follows:



- ❶ Place one or 2 Capsules of U/P on a glass slab. If using bulk powder, place a desired amount of powder onto the mixing slab.



- ❷ When mixing U/P Root Canal Sealer, place 1 drop of liquid for each capsule or scoop of powder.



- ❸ Using a cement spatula, drag small amounts of powder to the liquid and mix until the consistency is smooth.



- ❹ Continue adding powder until the desired working consistency is achieved. An ideal consistency is one where the mixed cement "pulls" about 1" or 25mm off the glass slab when the flat surface of the spatula is pulled away from the slab surface.

Sultan has a full line of operative products to serve your needs and treatment preferences.



BLEACHING AGENTS AND CEMENTS

Superoxol

(35% hydrogen peroxide)

Used to bleach non-vital teeth. Mix with sodium perborate for the walking bleach method.

Introduced into the pulp chamber and activated by heat source.

REF 11513

1oz (30ml)



Sodium Perborate

Oxygenating powder mixed with Superoxol to bleach non-vital teeth.

REF 11508

100gm

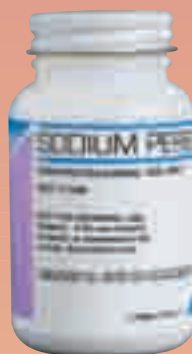

Eugenol U.S.P.

Antiseptic and analgesic. Used with zinc oxide powder for temporary cements and with zinc oxide and resins as a perio dressing. Ideal as an antiseptic in root canal therapy.

REF 10504

4oz (120ml)



Zinc Oxide Powder U.S.P.

Ideal for those who choose to formulate their own cements and root canal sealers; ZOE bases are compatible with hard and soft tissue and have a local anesthetic effect.

REF 11803

1.5oz (42gm)

REF 11804

1lb (453gm)



TECHNIQUE

Open the endo access hole, remove any leaking or stained fillings. Remove any gutta percha and sealer that may be covering the dentin inside the pulp chamber down to the level of the facial gingiva. Seal the canal spaces with composite resin or glass ionomer cement to prevent the bleaching paste from coming in contact with the endodontic filling material.



- 1 Mix the Sodium Perborate and Superoxol into a paste.



- 2 Place the paste into the pulp chamber using an amalgam carrier, composite syringe or any suitable instrument.



- 3 Seal the access hole with a temporary filling material. Evaluate the patient in 3-5 days and repeat the procedure if necessary.



Sodium Fluoride Desensitizing Paste 33-1/3%

33-1/3% Sodium fluoride in a glycerin base. Burnished into neck of tooth with ball burnisher or prophy cup to relieve thermal sensitivity. It's ideal for treating sensitivity caused by cervical erosion.

REF 11505

1oz (28gm)



Tincture Of Myrrh And Benzoin

(50% tincture of myrrh and 50% benzoin) Applied topically after perio surgery to form a protective film over soft tissue. Stimulates healing and acts as a mild antiseptic.

REF 11605

2oz (60ml)



Dentalone

(24% chlorobutanol, oil of cassia, oil of cloves, methyl salicylate) Used to quiet an inflamed pulp and as a dressing for nearly exposed pulp. Acts as a local anesthetic.

REF 10401

1oz (30ml)



Copal Cavity Varnish

(Copal resins, solvent) Protects dentin from acids released by filling materials. Provides a chemical and thermal barrier while eliminating air pockets. Needs no thinner!

REF 10314

2oz (60ml)

DRY SOCKET AND HEMOSTATIC

Greater Healing and Comfort

Our dry socket products promote healing and provide greater comfort. Our hemostatic products are helpful in controlling superficial bleeding during procedures, making your job easier and less traumatic for the patient.

Dry Socket Paste

(Active ingredients: Guaiacol 4.16%, Eugenol 4.16%)

Used to treat alveolitis. Gives instant pain relief. Paste is introduced into socket with flat-bladed instrument, tamped down to cover exposed bone, and allowed to remain in the socket 3-5 days. Paste washes out gradually as socket heals. A one-visit treatment with no packing to remove!

REF 10404

1 oz (28 gm)



Dry Socket Remedy

(20% benzocaine, gualacol, balsam peru)

Liquid treatment introduced into socket on iodoform gauze or absorbable hemostatic material. May be used to treat alveolitis.

REF 10405

1 oz (30 ml)



Hemoban

(25% aluminum chloride, no epinephrine)

Controls superficial bleeding during restorative procedures, placement of metal bands, cervical matrixes and crown preparations. Available in an economical 30ml size.

REF 10801

1oz (30ml)



TECHNIQUE



- 1 Introduce the Dry Socket Paste into the socket with a flat bladed instrument until socket is filled.



- 2 The socket is filled with Dry Socket Paste and the patient is sent home

Laboratory/General Products

From the hard-to-find to the everyday, we pride ourselves on providing a complete selection of operator, general dental office, preventive and laboratory products you need.



Mirror Defogger

Used as a mirror dip to maintain clear, bright images on mouth mirrors.

REF 20902 1qt (947ml)



Anti-Rust Powder

Contains Sodium Nitrite. Used with benzalkonium chloride and iodophors to protect metal from corrosion and rust.

REF 20103 1lb (453gm)



Orange Solvent

Used to dissolve ZOE and rubber-based materials for easy removal from instruments, mixing slabs and countertops. Contains lanolin. Non-irritating.

REF 21002 1qt (947ml)

Solvents

Chloroform
Eucalyptol U.S.P.
Xylol (Xylene)

REF 20390	8oz (237ml)
REF 10501	1oz (30ml)
REF 21401	1oz (30ml)

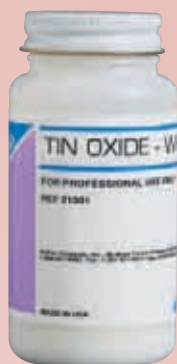

Tin Oxide

May be mixed with glycerine to make a paste suitable for polishing amalgams.

REF 21301 4oz (113gm)



Pressure Indicator Paste

When fitting and adjusting dentures, use Pressure Indicator Paste to identify high spots.

REF 21101 2oz (60ml)



Whisper™ Breath Freshener Spray

- Great tasting Topex® Mint Flavor
- Long lasting freshener is effective against breath odors caused by food, drink or tobacco
- Available in 4oz. Professional Size

REF AD31200 Whisper Breath Spray 4oz

Product Name/CATEGORY	Page	Product Name/CATEGORY	Page
1-SHOT™ Disposable Needles	63	G	
27/4 Preventive Care Guide	69	GENIE™ Bite	10-11
3WAY™ Disposable Impression Trays	14-15	GENIE™ Magic Mix	8-9
A		GENIE™ Putty	6-7
AMPHYL® Disinfectant Cleaner Concentrate	43	GENIE™ VPS Impression Material	6-7
AMPHYL® Disinfectant Spray	43	GlossCote	21
Anti-Rust Powder	88	GLOVE RELIEF™	45
ASEPT-ALL® Safety Glasses	48	Gun Racks	18
ASSURE PLUS™ Sterilization Pouches	60	H	
B		Hand Hygiene Products	43-45
Buckley's Formo Cresol	81	HANDICAINE STIX™ Unit Dose Topical Anesthetic Gel	71
C		Hemoban	87
Calcium Hydroxide Powder USP	79	HYDRO-CAST® Tissue Treatment	30-31
Camphorated Parachlorophenol USP	80	I	
CARE 4 Topical Fluoride Gel	72	IMPRESSION MATERIALS	6-13
Chloroform Liquid	89	INFECTION CONTROL PRODUCTS	34-65
CLEANLETS™ Ultrasonic Cleaning Tablets	57	INSTAFRESH™ Hand Sanitizer	47
COM-FIT™ Face Masks	49-51	Instrument Reprocessing	52-53
Copal Cavity Varnish	86	L	
D		LC Stain Kit	21
Dentalone	86	LYSOL® IC™ Antimicrobial Hand Soap	46
DENTRAY® II	16	LYSOL® IC™ Disinfectant Foam	42
Disclosing Solution	73	LYSOL® IC™ Disinfectant Spray	42
Disposable Impression Syringe	19	LYSOL® IC™ Quaternary Cleaner	43
Dry Socket Paste	87	LYSOL® IC™ Ready to Use Disinfectant Spray	43
Dry Socket Remedy	87	M	
DURASHIELD™ 5% Sodium Fluoride Varnish	76	MATERIALS AND RESTORATIVES	4-33
E		MCP Root Canal Dressing	81
ENDODONTIC PRODUCTS	78-83	Metacresylacetate (Cresatin)	81
Eugenol	85	Mirror Defogger	88
Eucalyptol NF	89	Mixing Tips	7
F			
Formo Cresol	80		



Product Name/CATEGORY	Page
O	
OPERATIVE PRODUCTS	86-87
Orange Solvent	88
P	
PEELPRO™ Sterilization Pouches	61
Pressure Indicator Paste	89
PREVENTIVE PRODUCTS	66-77
PRO•PORTION™ Cleaning Solutions	56
PRO•SONIC™ Ultrasonic Cleaning Machines	58-59
PRO•SONIC™ Ultrasonic Cleaning Solutions	57
ProSoak Soaking and Sterilizing Tray	62
ProSyringe	64
PRO-TIP® Ultra Air Water Syringe	
Tips & Converters	64-65
PUREVAC® Auto Walkabout Dispensing Unit	38-39
PUREVAC® Evacuation System Cleaner	38-39
PUREVAC® Hg Evacuation System Cleaner	36
S	
SENSITEMP® NEZO	24-25
SENSITEMP® Resin	24-25
SENSITEMP® ZOE	24-25
SILGIMIX™ Alginate Replacement Materials	12-13
SOAPLETS™ Antibacterial Foaming	
Hand Soap Tablets	45
Sodium Fluoride Desensitizing Paste	86
Sodium Hypochlorite	79
Sodium Perborate	85
Soft-Lined Fluoride Trays	75
SOLO™ Disinfectant Cleaners	40-41
Solmetex® Hg ⁵ Amalgam Separator	37
SPOROX® II Sterilizing Disinfectant Solution	62
SPOROX® II Test Vials	62
SULPAK™ and ULTRAX™ Retraction Cords	17
Superoxol	85
Surface Disinfectants	40-42
SURFLETS™ Disinfectant Tablets	44

Product Name/CATEGORY	Page
T	
TEMPART™ Acrylic Resin	22-23
Tin Oxide	89
Tinture Of Myrrh and Benzoin	86
TOPEX® APF 60 Second Fluoride Foam	74
TOPEX® APF 60 Second Fluoride Gel	74
TOPEX® Disposable Dual Arch Fluoride Trays	75
TOPEX® Disposable Single Arch Fluoride Trays	75
TOPEX® Metered Spray	71
TOPEX® Neutral pH Fluoride Foam	74
TOPEX® Neutral pH Fluoride Gel	74
TOPEX® Polishing Pastes	28-29
TOPEX® Prophy Paste	73
TOPEX® Take Home Care 0.4% Stannous Fluoride Gels	77
TOPEX® Take Home Care 1.1% Neutral Sodium Fluoride Gel	77
TOPEX® Topical Anesthetic Gel	70
TOUCH LESS™ Sanitizer Dispenser	45
TOUCH LESS™ Soap Dispenser	44
U	
U/P Root Canal Sealer/Cement	82
UPGRADE® Disposable Prophy Angle	72
V	
VERSA-LINK® Porcelain Bonding Kit	26-27
VERSA-SOFT™ Denture Soft Liner	32-33
VERSATEMP® Temporary Crown & Bridge Resin	20-21
W	
WHISPER™ Breath Freshener Spray	89
WHITECARE® Post-Whitening Desensitizer (1.1%NS)	77
X	
Xylol (Xylene)	89
Z	
Zinc Oxide Powder	89
ZYMEX™ Enzymatic Cleaner	54
ZYMEX™ Super Foaming Enzymatic Cleaner	55



Sultan Healthcare's Mission.

*To provide innovative quality products and services
that deliver continuous profitability to our
distribution partners and practitioners worldwide.*

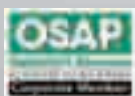

SultanHealthcare

330 South Van Brunt St., Englewood, NJ 07631 • Toll Free: 800-637-8582
Phone: 201-871-1232 • Fax: 201-871-0321 • www.sultanhealthcare.com

