

Pro-Matrix Band

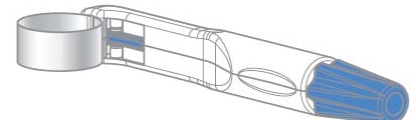

30010



Single-Use Matrix Band

30020

Item Codes & Packaging

| Item Code | Description | # of units per package | # of packages per case |
|-----------|---------------------------------|------------------------|------------------------|
| 30010 | Medicom Pro-Matrix–Wide 6.0 mm | 50 | 8 |
| 30020 | Medicom Pro-Matrix–Narrow 4.5mm | 50 | 8 |

Intended Use

Thin metal band which is tightened around the tooth to form a barrier and allow application of material. Used when performing fillings or similar operations.

Product Material

ABS, Nylon 66, Type 304 Stainless Steel Cold Rolled Coil
BPA Free
DEHP Free
Recyclable
Latex Free

Band Thickness

0.038mm

Colour

Wide: White & Blue
Narrow: White & Green

Usage

For single-use only

Country of Origin

China

Directions of Use:

1. Before use, adjust the toggle to suit the mouth quadrant in which the Pro-Matrix is being used. The toggle should be positioned closest to the gum-line to ensure the correct fit around the tooth.
2. Fit the band around the tooth and tighten by turning the thumbscrew clockwise.
3. Apply wedges and shape the band using a suitable burnishing tool if required.
4. To remove the band, loosen it by turning the handle 2-3 turns counter clockwise.

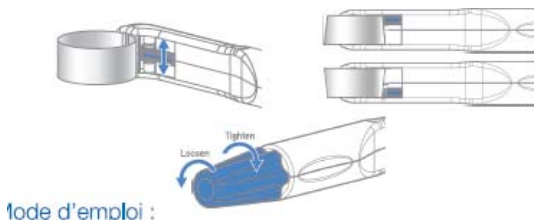

Mode d'emploi :