ADC-10

Portable Dental Stool

AseptiStool



**OPERATION MANUAL &
PARTS LIST**



! SAFETY PRECAUTIONS

Aseptico accepts no liability for direct or consequential injury or damage resulting from improper use, arising in particular through the non-observance of the operating instructions, or improper preparation and maintenance of this product.

To prevent injury to people and damage to property, please heed relevant warnings and remarks. They are marked as follows:

- **WARNING:** Serious injury or death may result if ignored.
- **CAUTION:** Damage to property or the environment may result if ignored.
- **NOTE:** Important additional information and hints.

▲ **WARNING:** Use for intended purposes only. Failure to observe the operating instructions may result in the patient or user suffering serious injury or the product being damaged, possibly beyond repair. Before using this product, make sure that you have studied and understood the operating instructions.

▲ **WARNING:** To avoid tipping hazard, never sit on the edge of the seat — always sit in the center of the seat.



▲ **WARNING:** Always use the stool on a hard flat surface.

▲ **WARNING:** The occupant's feet must be resting firmly on the floor when making height adjustments to the stool.

▲ **CAUTION:** Before using the Stool, ensure that the seat and base latches have securely locked the seat, gas-cylinder, and base components together.

▲ **CAUTION:** Do not disassemble or alter the gas-cylinder assembly.

▲ **CAUTION:** All repairs are to be performed by authorized service personnel only.

Congratulations!

Your new Aseptico ADC-10 portable stool is the finest adjustable gas-shock stool available to the dentistry and medical professions.

Features include:

- Quick setup and disassembly
- Stool seat height adjustable from 18" to 25.5" (45.7 to 64.8 cm)
- Quality vinyl covering
- Casters allow stool to be easily positioned
- Stool is designed for a 300 lb (136 kg) maximum load
- Stool weighs 19 lb (8.6 kg)
- Padded carrying case with handles
- Color Option: Gray, Blue, or Red
- Made in the USA

The ADC-10 portable stool is engineered to provide many years of reliable service. Please read the instructions provided in this manual to ensure the optimum service from your Aseptico equipment.

STOOL SETUP

1. Unzip the padded carrying case **A**. Place your hand under the front end of the seat **B** while lifting to hold the gas-cylinder **C** in place and keep it from falling and causing injury.

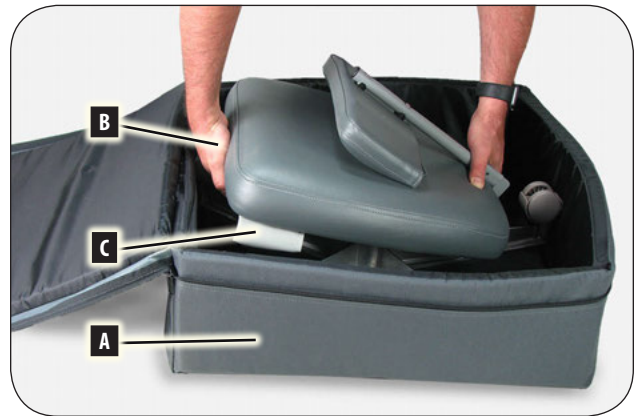

2. Turn over the seat **A** and lift the gas-cylinder **B** from its storage bracket **C**, then remove the gas-cylinder from its vinyl pouch.

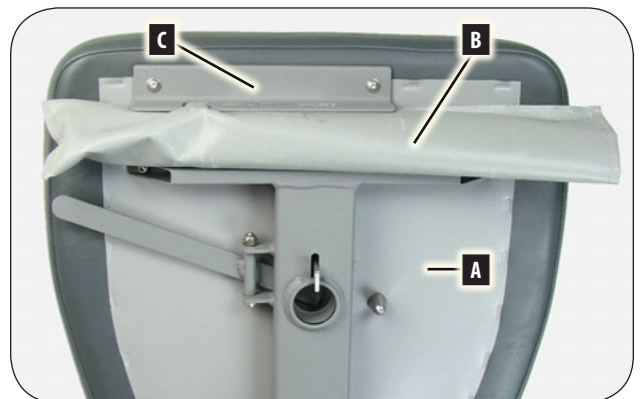

- Remove the base **A** from the padded carrying case and turn it over on its wheels, next to the gas-cylinder **B** and seat **C**.

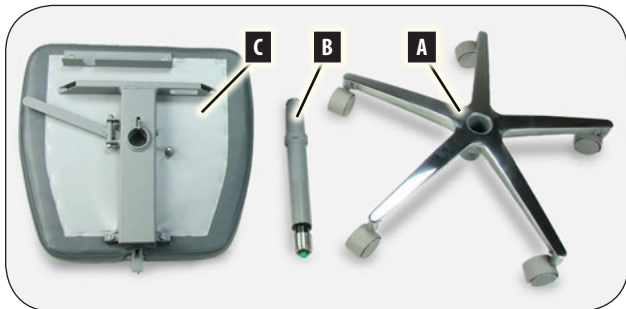

- Hold open the latch **A** on the seat frame while inserting the small end of the gas-cylinder **B** into the socket. Make sure the latch fully engages with the lip **C** on the end of the gas-cylinder.

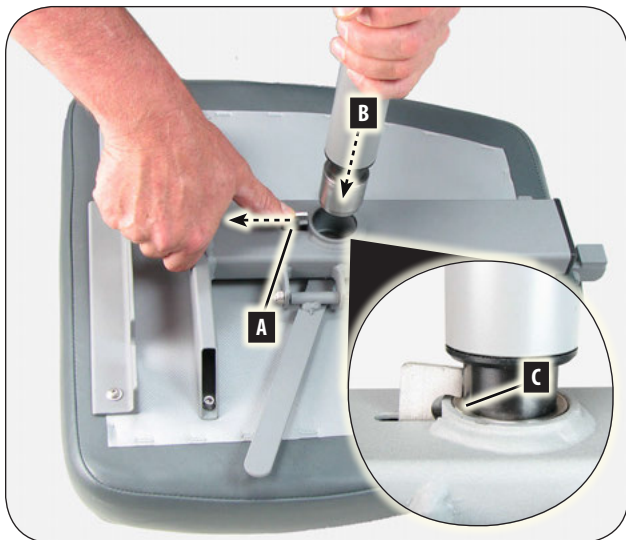

- Turn over the seat / gas-cylinder assembly **A** so the cylinder is pointing down. Pull and hold the latch **B** on the base while inserting the bottom end of the gas-cylinder **C** into the socket.



- Lift the stool up from the seat **A** to ensure that the gas cylinder **B** is securely latched at both ends. If either end separates, repeat steps 4-5 above to ensure both latches are properly engaged.



SEAT HEIGHT ADJUSTMENT

- To raise the seat, lift the height adjustment lever **A** with no weight on the seat. To lower the seat, lift the height adjustment lever while sitting on the seat.



DISASSEMBLY

1. Lower the seat all the way down and fold down the backrest.
2. Pull and hold the latch **A** on the base and lift the seat / gas-cylinder assembly **B** out of the base socket.



3. Turn over the seat / gas-cylinder assembly **A**. Hold open the latch **B** on the seat frame while lifting the gas-cylinder **C** out of the seat socket.



4. Turn over the base **A** and place it (wheels up) in the padded case with the latch **B** in any position EXCEPT the position shown with the "X" to prevent the latch from scratching the frame of the stool during transport.



5. Locate the metal ring **A** on the gas-cylinder; put this end of the gas-cylinder into its vinyl pouch first. Place the gas-cylinder (inside vinyl pouch) into the storage bracket on the bottom of the stool, making sure to fit the metal ring on the gas-cylinder **B** into the slot **C** on the storage bracket.



ADC-10

6. Hold the gas-cylinder **A** in place with one hand and locate the cone-shaped stud **B** with the other hand.

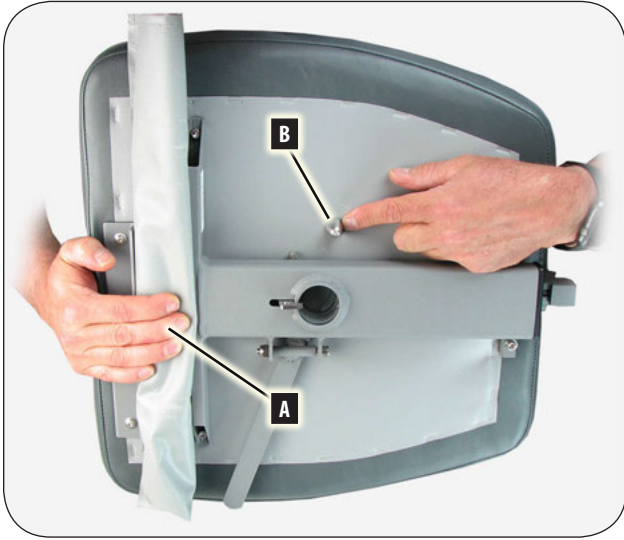

7. While continuing to hold the gas-cylinder **A** in place with one hand, use your other hand to guide the cone-shaped stud **B** on the bottom of the seat into the hole **C** in the center of the base.



8. All the stool components should fit together in the soft case as shown in the bottom view **A** and top view **B**.



9. Adjust the stool in the soft case as required to close the zipper. The soft bag is designed for a snug fit to hold components of the stool firmly. Place the soft case in the cardboard box.



ADC-10

PARTS	P/N	QTY
1 FINAL ASSY ADC-10 STOOL	120401	1
2 BACKREST CUSHION ASSY ADC-08	330074 (Gray) 330685 (Blue) 330744 (Red)	1
3 BACK SUPPORT ASSY PNTD ADC-08	330080	1
4 COLUMN STOOL ASSY ADC-09	330644	1
5 SEAT FRAME ADC-09 STOOL	330645	1
6 LEVER ASSY ADC-09 STOOL	330646	1
7 SEAT CUSHION ASSY ADC-09	330664 (Gray) 330687 (Blue) 330745 (Red)	1
8 HUB BASE ASSY ADC-10 STOOL	330669	1
9 RING SPRING LATCH	510928	1
10 CASE ADC-09 STOOL CARRYING GRY WITH LOGO	410213	1
11 SOCKET UPPER STRUT	462362	1
12 LATCH SEAT ADC-09 STOOL	462366	1
13 BUSHING COLUMN ADC-09 STOOL	462394	1
14 SPRING LATCH SEAT ADC-09 STOOL	462395	1
15 STUD PACKAGING ADC-09	462422	1
16 BRACKET COLUMN STORAGE ADC-09	462423	1
17 SLEEVE COLUMN ADC-09	462484	1
18 NUT NYLOC 10-32 STNLS	510124	1
19 C/S SOCHD STNLS 10-32X1-1/4	510140	2
20 SPACER NYLON 3/4 OD X .260 ID X .125 L COVED	510261	2
21 HOLE PLUG 3/4 NYLON BLK	510263	1
22 WOODSCREW FLAHDPHL #10 X 1.0L	510264	3
23 C/S BTNSOC STNLS 1/4-20 X 1-1/4	510295	2
24 NUT NYLOC 1/4-20 STNLS HEX	510296	1
25 WASHER FLAT STNLS #10	510356	2
26 C/S SOCHD STNLS 10-32 X 1-1/2	510872	1
27 C/S SOCHD STNLS 1/4-20 X 2-1/4	510885	1
28 C/S SOCHD STNLS 10-32 X 7/8	510887	2
29 C/S BTNSOC STNLS 10-32 X 7/8	510890	2
30 C/S BTNSOC STNLS 10-32 X 1-1/2	510891	1
31 WASHER FLAT STNLS #8 .188ID X .375OD	510897	2
32 HOLE PLUG RIBBED-RECTANGLE 1" X 2-1/2"	510898	1
33 CASTER 2" DUAL WHEEL 7/16X7/8 STEM GRY	730210	5
34 GAS CYLINDER ADVANCE PORTABLE STOOL ADC-09	730730	1
35 BASE 5-LEG 23.5" T-EDGE ALUM	730733	1
36 THREADED SPACER	462533	1

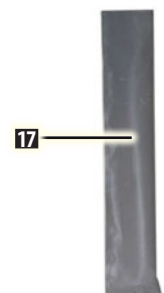
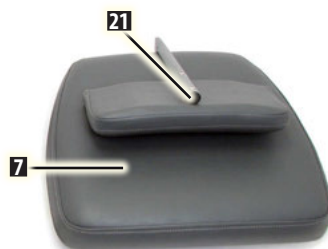
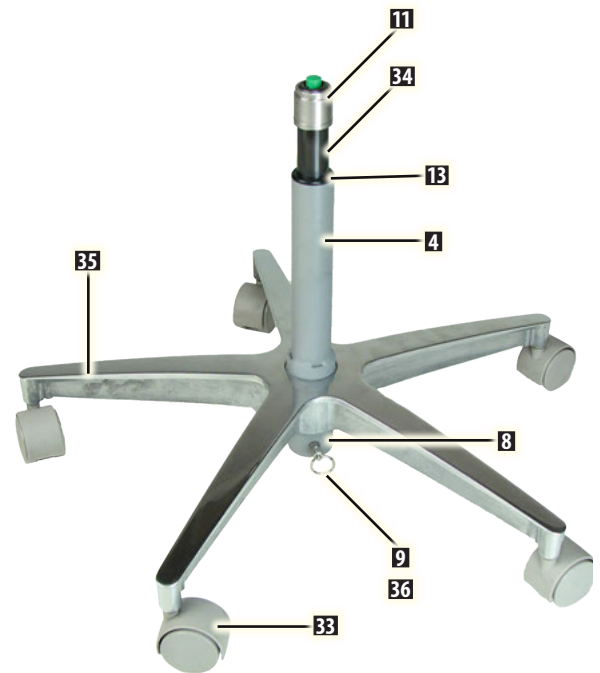
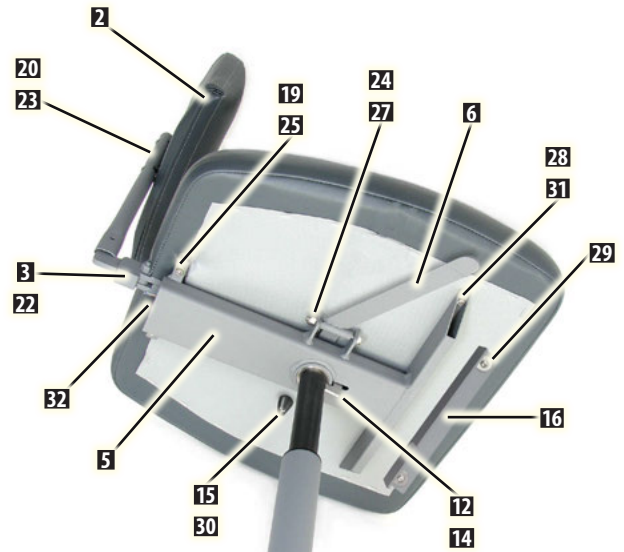

TROUBLESHOOTING

Stool seat cannot be raised or lowered -OR- Stool feels sluggish or jerky when the seat is raised or lowered.

- Disassemble gas cylinder from stool (refer to page 6 for disassembly instructions) and inspect cylinder for damage or excessive dirt buildup around cylinder piston. Replace cylinder if necessary.

Air is leaking from the gas cylinder.

- Remove and replace gas cylinder. Refer to parts list for part number and then contact asepticco to reorder.

WARRANTY

Asepticco Inc. warrants this product against defects in material or workmanship for a period of two (2) years, from date of original invoice. Some handpieces are warranted for one year under the same conditions. Other handpieces and expendable components, such as air turbines and light bulbs, are covered by shorter warranty periods, or have no warranty. Asepticco's sole obligation under product warranty is (at its sole option and discretion) to repair or replace any defective component or product in part or whole. Asepticco Inc. shall be the sole arbiter of such action.

In the event of alleged defect under warranty, the purchaser is to notify Asepticco's Customer Service Department promptly. Customer Service will provide instructions, usually directing that the product be returned for service. Shipment to Asepticco and the cost thereof is always the responsibility of the purchaser.

Accidental misuse, inappropriate installation, or failure to perform directed maintenance voids the warranty. Deliberately defacing, modifying, or removing the serial number voids the warranty.

Asepticco Inc. does not assume, under this warranty, any risks or liabilities arising from the clinical use of its products, whether or not such use involves coincidental utilization of products manufactured by others.

SYMBOL DEFINITIONS



Consult Instructions For Use



Caution – Consult Accompanying Documents



Manufacturer



Authorized European Representative



Serial Number



Part Number

SPECIFICATIONS

Dimensions:

Soft carrying case: 26" W x 26" L x 11" H (55.9 cm W x 55.9 cm L x 27.9 cm H)

Capacity:

300 lb (136 kg)

Range of Seat Positions:

Minimum Seat Height: 18" (45.7 cm)

Maximum Seat Height: 25.5" (64.8 cm)

Weight:

One (1) stool only: 19 lb (8.6 kg)

One (1) stool in soft carrying case: 24.5 lb (11.1 kg)

Color Option:

Gray, Blue, or Red

Manufacturer



Asepticco Inc
8333 216 St SE
Woodinville
WA 98072
USA

INFORMATION CONCERNING THE ACCURACY AND PRECISION OF THIS PRODUCT MAY BE OBTAINED UPON REQUEST BY CONTACTING ASEPTICO AT THE ADDRESS SHOWN ON THIS PAGE.



8333 216th Street S.E. Woodinville, WA 98072
Phone (425) 487-3157 • Toll Free (800) 426-5913
Web: www.aseptico.com
Email: info@aseptico.com